

Warrnambool Dog Training School Inc

A0013246X

**Back to Back Agility/Jumping/Obedience Trial
March 9th & 10th 2013**

Major Sponsor



A Message from the Trial Secretary:

From the Warrnambool Dog Training School Inc, we welcome you to our March 2013 Back to Back Obedience and Agility / Jumping Trial. The club wishes to extend our hospitality to all competitors and visitors over the trial weekend and we wish you every success in your events.

The WDTS also extends our thanks to all participating Judges and Stewards for their time and service during the trial. It's no trial without our VCA Representative to Pauline Gardner and our First Aid Officer Mr John Fulton, we thank you both for your time. To club members for their contribution in the lead up to the trial and over the two big days, to those who arrived early and assisted with the setting up of the rings and packing away of the equipment, to the Committee members and the Kitchen staff for their outstanding work, a big thank you for your support to the club and to myself.

Special thanks to the Portland club members who have offered their time to assist us in running the trial, and finally a special thank you to all competitors who have generously offered their time and assistance this weekend.

REMINDER TO ALL COMPETITORS:

The trials are held under the rules and regulations of the Victorian Canine Association Inc., a copy of which may be inspected in our club rooms.

Handlers handling two or more dogs, it is your responsibility to notify the ring steward of your situation in plenty of time before you are due to enter the ring, otherwise you will be marked absent after three calls. It is your responsibility to be at the ring when called.

Trials start at 8.30am each day. Check in for Obedience, Agility and Jumping 7.15am to 8.15 am each day.

Vetting for Obedience only from 7.15am to 8.15 am each day

The same competitor numbers for each dog over the two days for Agility/Jumping, Obedience numbers will be issued for each trial.

Afternoon trial will not start before 1.00pm on both days.

We wish you every success in our trial and hope you enjoy your stay in Warrnambool and please drive home safely.

Mick Byron Trial Secretary, Warrnambool Dog Training School Inc.



**Warrnambool Dog Training School Inc
Agility & Jumping Trials**

TRIAL PRECINCT

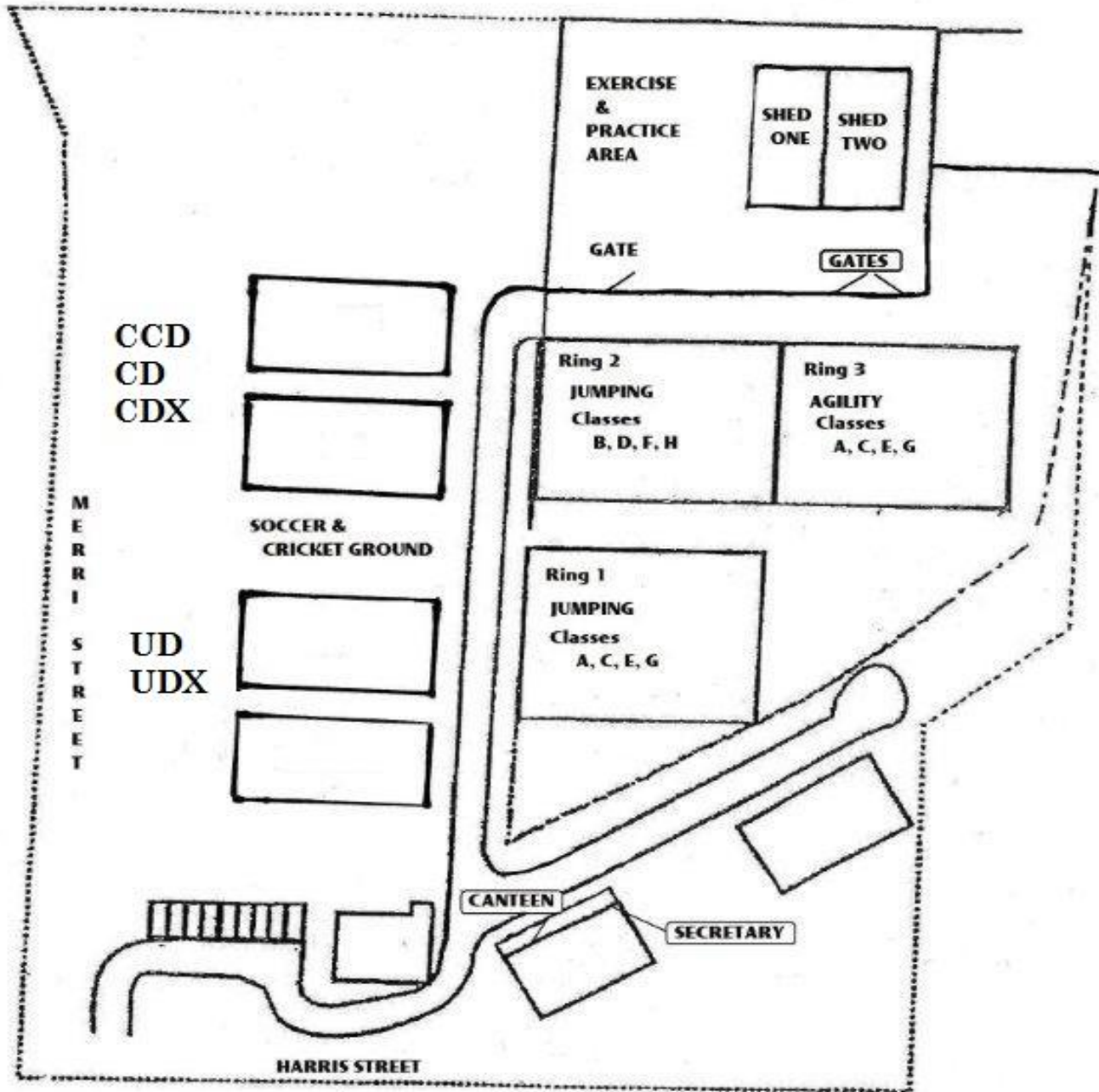

Contents:

Obedience Saturday AM	Page 5	Agility/Jumping Saturday AM	Page 7
Obedience Saturday PM	Page 19	Agility/Jumping Saturday PM	Page 21
Obedience Sunday AM	Page 31	Agility/Jumping Sunday AM	Page 33
Obedience Sunday PM	Page 45	Agility/Jumping Sunday PM	Page 46

LIST OF AWARDS

GENERAL AWARDS

Winner of each class

Sash and Trophy

Qualifying Score

Qualification Card and Sash

Title Gained on the Day

Sash

SPECIAL AWARDS

Best in trial – Obedience (each day)
Donated by Mick & Marg Byron

Trophy

Warrnambool Dog Training School
Highest Qualifying Score by Member

Sash – Obedience

Highest Scoring German Shepherd Dog
Donated by: Heldenhaft Kennels.

Trophy – Obedience

SPONSORS:



Anne Anderson
Mick & Marg Byron
Margo Salmon
Vivian O’Grady
Monaghan’s Pharmacy

Happy Trialing and have a great weekend

SATURDAY AM

Open - Mr Dave Rumble Saturday 9th March, 2013 (AM)

O101	ANNE MANN	KOMBINALONG SUPER SAPPHIRA CD RN	ASSOCIATE	B	430
O102	ASHAMBER KENNELS	ASHAMBER LK WHS TALKIN CD RA	GOLDEN RETRIEVER	D	590
O103	CHRIS WITTICK	GRAND CH HANAFOR BARETT BAILEY CD	HUNGARIAN VIZSLA	D	600
O104	LIZ SHARP	GRAEBROOK NO PEEKING CD	HUNGARIAN VIZSLA	B	540
O105	SHAUN GENTLE	MILAMGIMBI LILAC TWIST CD	BORDER COLLIE	D	510
O106	LINDENBRAE KENNELS	LINDENBRAE TARFIN DONNA	BORDER COLLIE	B	500
O107	LINDENBRAE KENNELS	LINDENBRAE TARFINELEKTRA	BORDER COLLIE	B	500
O108	DAWN GLANVILLE	JENUIN NINA SIMONE CD RE ADM JDX SD	POODLE (MINIATURE)	B	350

CDX	1 ST	SCORE
CDX	2 ND	SCORE
CDX	3 RD	SCORE

Novice - Mr Dave Rumble Saturday 9th March, 2013 (AM)

O109	CASSANDRA COLBERT	NESSII CCD	ASSOCIATE	S
O110	MRS P SCOTT	CH FLYNTAHN MERCEDES	POINTER	B
O111	MS KIERSTEN COULTER	NGALLA WISH UPON A STAR	AUSTRALIAN SHEPHERD	B
O112	N HARRY	WINTERSET SHADES OFBLUE QND RN	GOLDEN RETRIEVER	B
O113	NECIA LYNCH	DUAL CH TRACKING DEELEEE BAMBINI BERNARDO CCD RN	LAGOTTO ROMAGNOLO	D

CD	1 ST	SCORE
CD	2 ND	SCORE
CD	3 RD	SCORE

Community Companion Dog - Mr Dave Rumble Saturday 9th March, 2013 (AM)

O114	ASHAMBER KENNELS	CONINGSBURGH MAGICAL DIVA	LABRADOR RETRIEVER	B
O115	I. IRWIN	RASTI	ASSOCIATE	D
O116	KAREN KELLY HOURTICOLON	BRANDYMUZZA	ASSOCIATE	B
O117	KATHRYN HOLE	LYNSLINE BLUE JASPER	SHETLAND SHEEPDOG	D
O118	LOIS DOEVEN	OSCAR WILD	ASSOCIATE	N
O119	MR ROSS CARLSON	CH ELLAGANT TOP GUN RN	AUSTRALIAN SHEPHERD	D
O120	LISA MAREE FRY	ERNIE	ASSOCIATE	D
O121	MR GRAHAM A . WILKINSON	SEAMUS WILKINSON	ASSOCIATE	D
O122	MS D M JAMES D L RAE	CH ARANYBAJNOK HUNT MASTER ET	HUNGARIAN VIZSLA	D
O123	SUSAN KERWIN	MATAGANAH SAPPHIRE MOON	LABRADOR RETRIEVER	N

CCD	1 ST	SCORE
CCD	2 ND	SCORE
CCD	3 RD	SCORE

Utility Dog Excellent - Mrs Alison Rumble Saturday 9th March, 2013 (AM)

O124 MARTA MCKENZIE T.CH. YEOVILLE MASTERMINE UD ET RE BORDER COLLIE D 500

UDX	1 ST	SCORE
UDX	2 ND	SCORE
UDX	3 RD	SCORE

Utility - Mrs Alison Rumble Saturday 9th March, 2013 (AM)

O125	REBECCA MCGROARTY	HEVNSENT SWEET BABYBLU CDX	AUSTRALIAN SHEPHERD	B	500
O126	ANNE MANN	ZOE UD RE TD ET	ASSOCIATE	B	470
O127	LIZ SHARP	HUBERTUS IRESISTIBLE ISH CDX	HUNGARIAN VIZSLA	B	610
O128	RON SCIBERRAS	SPRITZEE INFLIGHT CDX	SCHNAUZER (MIN.)	D	350
O129	ADRIAN AND RANA BROGAN	JAMARANG BISKIT BROGAN CDX ET RA TCH AUSSIELAB MIDSUMMERDREAM CDX	GOLDEN RETRIEVER	D	600
O130	ASHAMBER KENNELS	JD RE	LABRADOR RETRIEVER	B	530

UD	1 ST	SCORE
UD	2 ND	SCORE
UD	3 RD	SCORE



Novice Agility (A) - Adrian Tilley**Saturday 9th March, 2013 (AM)**

300				
302	CAROLE DENEHEY	HENDERCHIP DARTAGNAN JDX FD	(POODLE (TOY))	1
400				
409	MRS K MR G TAYLOR	SILVANWOOD HELLS BELLS RN JD	(AUSSIE)	2
412	MRS H M EAVES	RICOCHÉZ DYFRI LILI RHOSLYN TDX	(WELSHIE)	3
414	SALLY BURGESS	OLIVERJAMES RN	(ASSOC)	4
417	BEL ADELE KENNELS / ANGIE GUNTHER	BEL ADELE XTREME XTACY CCD JDX	(BC)	5
419	MRS M HOLCOMBE	TEALC JD	(ASSOC)	6
500				
509	MS KIERSTEN COULTER	COMEBY MORE THAN ME	(AUSSIE)	7
529	MRS ROSALINE TWAITES DR R ATYEO	YEOVILLE MISS INDEPENDENT HT	(BC)	8
549	KATE SCOTT	BELADELE XTREME XCESS JD	(BC)	9
559	G KISIELNICKI	KAYLADENE ROXYZ LIL ROCKET	(BC)	10
563	SARAH GREENSTREET	AMAZINGGRACIE	(ASSOC)	11
566	MRS M J CORRY-THOMAS	SHANOWL QUIZA WHIZZ SPICE	(BC)	12
573	K K KISIELNICKI	KAYLADENE IGNITE MY FIRE	(BC)	13
600				
615	SUSAN KERWIN	ALANGLÉN KEEP THE FAITH CDX ET	(LAB)	14
618	PETER MARMO	ROZATE THE SEA HAWK	(AUSSIE)	15
621	MR M HOLCOMBE	PAIGE	(ASSOC)	16
623	ADRIAN AND RANA BROGAN	JAMARANG BISKIT BROGAN CDX ET RA	(GOLDIE)	17

Open Agility (A) - Adrian Tilley**Saturday 9th March, 2013 (AM)**

400				
408	SHARON MULSHINE	LUCY ADM ADO5 JDX JDO3 SD SPD	(IGGY)	35
411	TINA CHESWORTH	ALCLUTHA KILTS A FLYIN ADM JDX GD SPDX ADO SD	(SHELTIE)	36
412	MRS H M EAVES	RICOCHÉZ DYFRI LILI RHOSLYN TDX	(WELSHIE)	37
415	MR SCOTT FLETCHER	JEOLENA BOY CANNY GO ADM ADO GDX JDM JDO SPDX SDX	(STAFFIE)	38
416	M A SCHNIDER	MONTULATA JADES GEM CCD ADX JDX SD GD SPD	(BC)	39
500				
512	MR G MRS J MILNER	AG CH YEOVILLE ACCIDENTAL HERO ADM JDM ADO JDO GDM SDM SPDM CD HSAS	(BC)	40
514	STEVE AND TERRI ROSE	KADNOOK BLAZE OF GLORY ADX JD	(LAB)	41

525	JANINE FEIL	PADDINGTON CDX ADX JDX RN	(ASSOC)	42
544	J. LEWIS L. LLOYD	GWAERFEYN IVY AD JDX	(BC)	43
555	LYNN MUSSETT	PORUSE DUALY BUILT CD JDX AD RN	(AUSSIE)	44
564	LEIGH STRETTON	ASHA (JD)	(BC)	45
567	MEREDITH MARSHALL	MACZE JDX ADX SPD SD GD	(ASSOC)	46
576	MRS SL AND MR AC SANDERSON	ALANGLEN ARWEN ROSE CD ADM ADO JDM JDO SD SPDX GDX	(LAB)	47
600				
602	KATE DALL	TJUKURPA TRAPPER AD JDX	(KOOLIE)	48
603	DR J M MAGAREY	FLYNN JDX ADX SPD SDX GD	(BC)	49
605	STEVE AND TERRI ROSE	KADNOOK GROUSES LEGEND ADM JDX	(LAB)	50
612	R L PADFIELD	JAZPA CD ADX JDX JDO ADO SPD	(ASSOC)	51
617	L K HAMMER AND K A EDWARDS	FENRIK MURPHYS OUTLAW ADM3 ADO3 JDM6 JFO4 SDM GDM SPDM	(GSP)	52
619	MICHAEL CHESWORTH	KAYLADENE TAKE IT EASY ADX JDX SPD	(BC)	53

Excellent Agility (A) - Adrian Tilley

Saturday 9th March, 2013 (AM)

200				
201	TAMMY BEATTIE	MADDOGMADISON AD JDX	(ASSOC)	18
202	KYLEY CONDER	CHEZJOLIE FANCY STUFF CCD JDX AD RN	(POODLE (TOY))	19
300				
301	VICKI JOSEPHS	SUMMASTORM JDX AD SDX SPDX GD CCD	(TERRIER)	20
400				
401	VICKI JOSEPHS	DEMON AD JD SPD SD RN	(POODLE (MIN))	21
500				
505	KATE DALL	TJUKURPA WILLOW AD JDM	(KOOLIE)	22
507	DR J M MAGAREY	GUIRMERE SCOUT GDSPDADSD	(BC)	23
536	STEPHEN PEARSON	ICEANA MERCURY RISEN ET AD JD SPD	(VIZSLA)	24
544	J. LEWIS L. LLOYD	GWAERFEYN IVY AD JDX	(BC)	25
552	SARAH CROCKER	MACDONALD AD JDX SPD	(ASSOC)	26
555	LYNN MUSSETT	PORUSE DUALY BUILT CD JDX AD RN	(AUSSIE)	27
558	MR GARRY C HEINZE	BILLYDOGHEINZE AD JDX	(ASSOC)	28
564	LEIGH STRETTON	ASHA (JD)	(BC)	29
572	PAULINE GARDNER	DALLAS GARDNER AD JD	(ASSOC)	30
577	KATIE BUGEJA	BLACKDIAMONDTOPY AD JD	(ASSOC)	31
600				
602	KATE DALL	TJUKURPA TRAPPER AD JDX	(KOOLIE)	32
609	CAMILLA SLEETH	BLUEGRACE SEA CALLING AD JD	(PWD)	33

613	GARY STOCKMAN	KIWI MATAI JDX AD	(ASSOC)	34
-----	---------------	-------------------	---------	----

Masters Agility (A) - Adrian Tilley

Saturday 9th March, 2013 (AM)

300				
303	S. T. OBRIEN	HENDERCHIP KICKNUP DUST JDM JDO ADX	(POODLE (TOY))	54
305	SHARON MULSHINE	BINDI CD ADM ADO2 JDM JDO2 SD GD	(IGGY)	55
307	DAWN GLANVILLE	JENUIN NINA SIMONE CD RE ADM JDX SD	(POODLE (MIN))	56
309	MS MICHELE MOORE	TOONEYBANK STOPYA NAGGN ADX JDM SDX GD SPD	(SHELTIE)	57
400				
403	CAROLE DENEHEY	PHINEAS FOGG JDM ADM GD SDX SPDM JDO ADO TD FMX	(ASSOC)	58
407	VANESSA LOUGHLIN	GLENMAVE CHAIN REACTION ADM JDX	(NSDTR)	59
413	SUE GONELLI	LEAPIN LEXIE ADM JDM SPDX GD SD	(ASSOC)	60
415	MR SCOTT FLETCHER	JEOLENA BOY CANNY GO ADM ADO GDX JDM JDO SPDX SDX	(STAFFIE)	61
416	M A SCHNIDER	MONTULATA JADES GEM CCD ADX JDX SD GD SPD	(BC)	62
421	LUKE WILBY	ELSPAN BARKLY BLUE ADX JDX	(COCKER)	63
500				
502	STEPHEN PEARSON	FIDELS IN HOT PURSUIT ADX JDX	(BC)	64
511	JULIE LYON	ALBAJAIL EMBRACE THE RACE ADX JDX	(AUSSIE)	65
512	MR G MRS J MILNER	AG CH YEOVILLE ACCIDENTAL HERO ADM JDM ADO JDO GDM SDM SPDM CD HSAS	(BC)	66
513	G KISIELNICKI	AG CH GUIRMERE JAZZ ADM JDM ADO JDO SPD GDX SD	(BC)	67
514	STEVE AND TERRI ROSE	KADNOOK BLAZE OF GLORY ADX JD	(LAB)	68
518	K K KISIELNICKI	AG CH 500 KAYLADENE BORN TO RUN JDM ADM JDO ADO SPD	(BC)	69
519	VANESSA LOUGHLIN	MAGPIELANE SIGHING WIND CD ADM ADO3 JDM JDO4 GD SPD SD	(NSDTR)	70
525	JANINE FEIL	PADDINGTON CDX ADX JDX RN	(ASSOC)	71
526	RENEE PATTEN	T CH WILLIAM THEBLOODY CDX ET ADM JDM ADO JDO SDM GDX SPDX DWDFH HTMN RN	(ASSOC)	72
527	ANNE WARREN	KANEKY ROYAL EDITION ADM ADO GD SD JDX JDO SPD	(TERRIER (MAN))	73
532	HEATHER DONALDSON	RICKY DONALDSON ADX JDM	(ASSOC)	74
541	JULIE LYON ANA RICHARDSON	ELLAGANT ITS IN THE GENES ADX JDO JDM2 SPD GDX	(AUSSIE)	75
543	G KISIELNICKI	AG CH KAYLADENE CHOC ROYAL ADM JDM ADO JDO SPDM GDX SDG	(BC)	76

546	K K KISIELNICKI	AG CH KAYLADENE TRIPLE CHOC ADM JDM ADO JDO SPDM GDX SDX	(BC)	77
551	KERRIE L RYAN	BAILEY GIRL ADM JDM	(ASSOC)	78
554	R FAGAN	MACYS MYSTIC BLUE SAPPHIRE ADM JDM ADO JDO CD FM	(AUSSIE)	79
568	MEGAN SEMPLE	T CH ALANGLLEN JINDABYNE ROSE CCD ADM JDM SDX SPDX ET	(LAB)	80
569	JULIE LYON	SHEPALIAN DREAMS UNWIND ADM ADO JDM JDO GD SD SPD (IMP UK)	(AUSSIE)	81
575	SANDY STOCKMAN	JETI KNIGHT JDX ADX GD	(KELPIE)	82
576	MRS SL AND MR AC SANDERSON	ALANGLLEN ARWEN ROSE CD ADM ADO JDM JDO SD SPDX GDX	(LAB)	83
600				
603	DR J M MAGAREY	FLYNN JDX ADX SPD SDX GD	(BC)	84
607	L K HAMMER AND K A EDWARDS	FENIK LIQUORICE ALSPORT ADM2 ADO JDM JDO SDX GDX SPDM	(GSP)	85
611	MRS JENNY WILLIAMS	ROBBIE JAY ADX ADO JDO JDM	(ASSOC)	86
612	R L PADFIELD	JAZPA CD ADX JDX JDO ADO SPD	(ASSOC)	87
617	L K HAMMER AND K A EDWARDS	FENRIK MURPHYS OUTLAW ADM3 ADO3 JDM6 JFO4 SDM GDM SPDM	(GSP)	88
619	MICHAEL CHESWORTH	KAYLADENE TAKE IT EASY ADX JDX SPD	(BC)	89
622	MIKA PEACE	DYKINTA RED ALERT ADM JDM ADO JDO GDX SD SPD	(AUSSIE)	90
625	L K HAMMER AND K A EDWARDS	PACE VON DER MADLAGE (IMP DEU) ADX ADO JDX SD GD SPDX	(GSP)	91

Open Jumping (A) - Clive Makepeace

Saturday 9th March, 2013 (AM)

400				
408	SHARON MULSHINE	LUCY ADM ADO5 JDX JDO3 SD SPD	(IGGY)	108
411	TINA CHESWORTH	ALCLUTHA KILTS A FLYIN ADM JDX GD SPDX ADO SD	(SHELTIE)	109
412	MRS H M EAVES	RICOCHERZ DYFRI LILI RHOSLYN TDX	(WELSHIE)	110
500				
512	MR G MRS J MILNER	AG CH YEOVILLE ACCIDENTAL HERO ADM JDM ADO JDO GDM SDM SPDM CD HSAS	(BC)	111
525	JANINE FEIL	PADDINGTON CDX ADX JDX RN	(ASSOC)	112
532	HEATHER DONALDSON	RICKY DONALDSON ADX JDM	(ASSOC)	113
541	JULIE LYON ANA RICHARDSON	ELLAGANT ITS IN THE GENES ADX JDO JDM2 SPD GDX	(AUSSIE)	114
542	MR G MRS J MILNER	GUIRMERE RUM RUNNER JDX HT	(BC)	115
552	SARAH CROCKER	MACDONALD AD JDX SPD	(ASSOC)	116

553	MRS EMI HINAGO MR DEAN CROSTHWAITE	GUIRMERE BLUEMOON NIAH JD AD	(BC)	117
557	MRS EMI HINAGO MR DEAN CROSTHWAITE	SEAMIST KIARA JD	(BC)	118
558	MR GARRY C HEINZE	BILLYDOGHEINZE AD JDX	(ASSOC)	119
574	SARAH MCDOWELL	ZAC JD	(BC)	120
575	SANDY STOCKMAN	JETI KNIGHT JDX ADX GD	(KELPIE)	121
600				
603	DR J M MAGAREY	FLYNN JDX ADX SPD SDX GD	(BC)	122
609	CAMILLA SLEETH	BLUEGRACE SEA CALLING AD JD	(PWD)	123
612	R L PADFIELD	JAZPA CD ADX JDX JDO ADO SPD	(ASSOC)	124
613	GARY STOCKMAN	KIWI MATAI JDX AD	(ASSOC)	125
625	L K HAMMER AND K A EDWARDS	PACE VON DER MADLAGE (IMP DEU) ADX ADO JDX SD GD SPDX	(GSP)	126

Excellent Jumping (A) - Clive Makepeace Saturday 9th March, 2013 (AM)

500				
503	REBEKAH FOORD	ELLAGANT HIDE AND SEEK CCDJD	(AUSSIE)	127
517	ASHAMBER KENNELS	TCH AUSSIELAB MIDSUMMERDREAM CDX JD RE	(LAB)	128
524	MRS K MR G TAYLOR	NGALLA ONE OF THESE NIGHTS RN AD JD	(AUSSIE)	129
549	KATE SCOTT	BELADELE XTREME XCESS JD	(BC)	130
553	MRS EMI HINAGO MR DEAN CROSTHWAITE	GUIRMERE BLUEMOON NIAH JD AD	(BC)	131
557	MRS EMI HINAGO MR DEAN CROSTHWAITE	SEAMIST KIARA JD	(BC)	132
564	LEIGH STRETTON	ASHA (JD)	(BC)	133
572	PAULINE GARDNER	DALLAS GARDNER AD JD	(ASSOC)	134
574	SARAH MCDOWELL	ZAC JD	(BC)	135
577	KATIE BUGEJA	BLACKDIAMONDToby AD JD	(ASSOC)	136
600				
604	FIONA COLENZO	ABBIESTAR SPECIALIZED JD	(VIZSLA)	137
608	MRS K MR G TAYLOR	AUSSIE BUNDY CCD RN JD	(ASSOC)	138
609	CAMILLA SLEETH	BLUEGRACE SEA CALLING AD JD	(PWD)	139
616	FIONA COLENZO	CH ABBIESTAR MADE TO ORDER JD	(VIZSLA)	140
626	MALCOLM BIRD	BROOKSVALE LEICA AD JD	(BELGIAN)	141

Masters Jumping (A) - Clive Makepeace Saturday 9th March, 2013 (AM)

200				
201	TAMMY BEATTIE	MADDOGMADISON AD JDX	(ASSOC)	142
202	KYLEY CONDER	CHEZJOLIE FANCY STUFF CCD JDX AD RN	(POODLE (TOY))	143
300				
302	CAROLE DENEHEY	HENDERCHIP DARTAGNAN JDX FD	(POODLE (TOY))	144
303	S. T. OBRIEN	HENDERCHIP KICKNUP DUST JDM JDO ADX	(POODLE (TOY))	145
305	SHARON MULSHINE	BINDI CD ADM ADO2 JDM JDO2 SD GD	(IGGY)	146
307	DAWN GLANVILLE	JENUIN NINA SIMONE CD RE ADM JDX SD	(POODLE (MIN))	147
309	MS MICHELE MOORE	TOONEYBANK STOPYA NAGGN ADX JDM SDX GD SPD	(SHELTIE)	148
400				
402	BEL ADELE KENNELS / ANGIE GUNTHER	BEL ADELE UR UNIQUE. CDX AD JDX	(BC)	149
404	LAURA DISTEFANO	AG CH 400 NELLIE GIRL ADM ADO JDM JDO HT PT GD	(ASSOC)	150
405	S. T. OBRIEN	DEBONAIR DARCY ADM ADO JDM JDO SPDM GD	(ASSOC)	151
407	VANESSA LOUGHLIN	GLENMAVE CHAIN REACTION ADM JDX	(NSDTR)	152
413	SUE GONELLI	LEAPIN LEXIE ADM JDM SPDX GD SD	(ASSOC)	153
415	MR SCOTT FLETCHER	JEOLENA BOY CANNY GO ADM ADO GDX JDM JDO SPDX SDX	(STAFFIE)	154
417	BEL ADELE KENNELS / ANGIE GUNTHER	BEL ADELE XTREME XTACY CCD JDX	(BC)	155
421	LUKE WILBY	ELSPAN BARKLY BLUE ADX JDX	(COCKER)	156
500				
501	JESS HARMSWORTH	DARCY DIVA CDX ADM JDM ADO JDO GDX SD	(ASSOC)	157
505	KATE DALL	TJUKURPA WILLOW AD JDM	(KOOLIE)	158
506	PATRICIA ATTARD PAUL WARD	HOLLY GOLIGHTLY ADM JDM JDO ADO SPMD	(ASSOC)	159
511	JULIE LYON	ALBAJAIL EMBRACE THE RACE ADX JDX	(AUSSIE)	160
512	MR G MRS J MILNER	AG CH YEOVILLE ACCIDENTAL HERO ADM JDM ADO JDO GDM SDM SPDM CD HSAS	(BC)	161
513	G KISIELNICKI	AG CH GUIRMERE JAZZ ADM JDM ADO JDO SPD GDX SD	(BC)	162
518	K K KISIELNICKI	AG CH 500 KAYLADENE BORN TO RUN JDM ADM JDO ADO SPD	(BC)	163
519	VANESSA LOUGHLIN	MAGPIELANE SIGHING WIND CD ADM ADO3 JDM JDO4 GD SPD SD	(NSDTR)	164

525	JANINE FEIL	PADDINGTON CDX ADX JDX RN	(ASSOC)	165
526	RENEE PATTEN	T CH WILLIAM THEBLOODY CDX ET ADM JDM ADO JDO SDM GDX SPD DWDFH HTMN RN	(ASSOC)	166
535	JESS HARMSWORTH	ZEE AD JDX GD	(ASSOC)	167
537	REBEKAH FOORD	MACYS MINIATURE PATCHES CDADO7ADM4JDM6JDO5GDSPXFDM	(AUSSIE)	168
538	PATRICIA ATTARD PAUL WARD	SCOUTS HONOUR AD JDM	(ASSOC)	169
541	JULIE LYON ANA RICHARDSON	ELLAGANT ITS IN THE GENES ADX JDO JDM2 SPD GDX	(AUSSIE)	170
542	MR G MRS J MILNER	GUIRMERE RUM RUNNER JDX HT	(BC)	171
543	G KISIELNICKI	AG CH KAYLADENE CHOC ROYAL ADM JDM ADO JDO SPDM GDX SDG	(BC)	172
544	J. LEWIS L. LLOYD	GWAERFEYN IVY AD JDX	(BC)	173
546	K K KISIELNICKI	AG CH KAYLADENE TRIPLE CHOC ADM JDM ADO JDO SPDM GDX SDX	(BC)	174
551	KERRIE L RYAN	BAILEY GIRL ADM JDM	(ASSOC)	175
552	SARAH CROCKER	MACDONALD AD JDX SPD	(ASSOC)	176
554	R FAGAN	MACYS MYSTIC BLUE SAPPHIRE ADM JDM ADO JDO CD FM	(AUSSIE)	177
555	LYNN MUSSETT	PORUSE DUALY BUILT CD JDX AD RN	(AUSSIE)	178
556	MS TRICIA DUNLOP	SASSYBRAT JDX AD	(BC)	179
568	MEGAN SEMPLE	T CH ALANGLN JINDABYNE ROSE CCD ADM JDM SDX SPD ET	(LAB)	180
569	JULIE LYON	SHEPALIAN DREAMS UNWIND ADM ADO JDM JDO GD SD SPD (IMP UK)	(AUSSIE)	181
571	BELINDA TEBBET	DARGO TEBBET AD JDX SD ET	(ASSOC)	182
575	SANDY STOCKMAN	JETI KNIGHT JDX ADX GD	(KELPIE)	183
576	MRS SL AND MR AC SANDERSON	ALANGLN ARWEN ROSE CD ADM ADO JDM JDO SD SPD GDX	(LAB)	184
600				
602	KATE DALL	TJUKURPA TRAPPER AD JDX	(KOOLIE)	185
603	DR J M MAGAREY	FLYNN JDX ADX SPD SDX GD	(BC)	186
607	L K HAMMER AND K A EDWARDS	FENIK LIQUORICE ALSPORT ADM2 ADO JDM JDO SDX GDX SPDM	(GSP)	187
611	MRS JENNY WILLIAMS	ROBBIE JAY ADX ADO JDO JDM	(ASSOC)	188
612	R L PADFIELD	JAZPA CD ADX JDX JDO ADO SPD	(ASSOC)	189
613	GARY STOCKMAN	KIWI MATAI JDX AD	(ASSOC)	190
617	L K HAMMER AND K A EDWARDS	FENRIK MURPHYS OUTLAW ADM3 ADO3 JDM6 JFO4 SDM GDM SPDM	(GSP)	191
619	MICHAEL CHESWORTH	KAYLADENE TAKE IT EASY ADX JDX SPD	(BC)	192
622	MIKA PEACE	DYKINTA RED ALERT ADM JDM ADO JDO GDX SD SPD	(AUSSIE)	193
625	L K HAMMER AND K A EDWARDS	PACE VON DER MADLAGE (IMP DEU) ADX ADO JDX SD GD SPD	(GSP)	194

Novice Jumping (A) - Clive Makepeace**Saturday 9th March, 2013 (AM)**

300				
311	VICKI JOSEPHS	GLORI	(TERRIER)	92
313	TINA CHESWORTH	YACKAWIL YESTERDAYS DREAM	(SHELTIE)	93
400				
412	MRS H M EAVES	RICOCHEZ DYFRI LILI RHOSLYN TDX	(WELSHIE)	94
500				
507	DR J M MAGAREY	GUIRMERE SCOUT GDSPDADSD	(BC)	95
509	MS KIERSTEN COULTER	COMEBY MORE THAN ME	(AUSSIE)	96
528	VIVIAN O GRADY	MATILDAOGRADY	(ASSOC)	97
529	MRS ROSALINE TWAITES DR R ATYEO	YEOVILLE MISS INDEPENDENT HT	(BC)	98
548	MRS K MR G TAYLOR	AUSSIE MIA RN	(ASSOC)	99
559	G KISIELNICKI	KAYLADENE ROXYZ LIL ROCKET	(BC)	100
563	SARAH GREENSTREET	AMAZINGGRACIE	(ASSOC)	101
565	ELAINE RAWILLER	COOPERRAWILLER	(ASSOC)	102
566	MRS M J CORRY-THOMAS	SHANOWL QUIZA WHIZZ SPICE	(BC)	103
573	K K KISIELNICKI	KAYLADENE IGNITE MY FIRE	(BC)	104
600				
614	MS D M JAMES D L RAE	CH ARANYBAJNOK HUNT MASTER ET	(VIZSLA)	105
615	SUSAN KERWIN	ALANGLLEN KEEP THE FAITH CDX ET	(LAB)	106
618	PETER MARMO	ROZATE THE SEA HAWK	(AUSSIE)	107

Masters Jumping (B) - Murray Tyler**Saturday 9th March, 2013 (AM)**

600				
625	L K HAMMER AND K A EDWARDS	PACE VON DER MADLAGE (IMP DEU) ADX ADO JDX SD GD SPDX	(GSP)	195
622	MIKA PEACE	DYKINTA RED ALERT ADM JDM ADO JDO GDX SD SPD	(AUSSIE)	196
619	MICHAEL CHESWORTH	KAYLADENE TAKE IT EASY ADX JDX SPD	(BC)	197
613	GARY STOCKMAN	KIWI MATAI JDX AD	(ASSOC)	198
611	MRS JENNY WILLIAMS	ROBBIE JAY ADX ADO JDO JDM	(ASSOC)	199
605	STEVE AND TERRI ROSE	KADNOOK GROUSES LEGEND ADM JDX	(LAB)	200
603	DR J M MAGAREY	FLYNN JDX ADX SPD SDX GD	(BC)	201
500				
576	MRS SL AND MR AC SANDERSON	ALANGLLEN ARWEN ROSE CD ADM ADO JDM JDO SD SPDX GDX	(LAB)	202
575	SANDY STOCKMAN	JETI KNIGHT JDX ADX GD	(KELPIE)	203

569	JULIE LYON	SHEPALIAN DREAMS UNWIND ADM ADO JDM JDO GD SD SPD (IMP UK)	(AUSSIE)	204
568	MEGAN SEMPLE	T CH ALANGLN JINDABYNE ROSE CCD ADM JDM SDX SPD ET	(LAB)	205
567	MEREDITH MARSHALL	MACZE JDX ADX SPD SD GD	(ASSOC)	206
558	MR GARRY C HEINZE	BILLYDOGHEINZE AD JDX	(ASSOC)	207
556	MS TRICIA DUNLOP	SASSYBRAT JDX AD	(BC)	208
554	R FAGAN	MACYS MYSTIC BLUE SAPPHIRE ADM JDM ADO JDO CD FM	(AUSSIE)	209
552	SARAH CROCKER	MACDONALD AD JDX SPD	(ASSOC)	210
551	KERRIE L RYAN	BAILEY GIRL ADM JDM	(ASSOC)	211
546	K K KISIELNICKI	AG CH KAYLADENE TRIPLE CHOC ADM JDM ADO JDO SPDM GDX SDX	(BC)	212
544	J. LEWIS L. LLOYD	GWAERFEYN IVY AD JDX	(BC)	213
543	G KISIELNICKI	AG CH KAYLADENE CHOC ROYAL ADM JDM ADO JDO SPDM GDX SDG	(BC)	214
542	MR G MRS J MILNER	GUIRMERE RUM RUNNER JDX HT	(BC)	215
541	JULIE LYON ANA RICHARDSON	ELLAGANT ITS IN THE GENES ADX JDO JDM2 SPD GDX	(AUSSIE)	216
538	PATRICIA ATTARD PAUL WARD	SCOUTS HONOUR AD JDM	(ASSOC)	217
537	REBEKAH FOORD	MACYS MINIATURE PATCHES CDADO7ADM4JDM6JDO5GDXSPXFD	(AUSSIE)	218
535	JESS HARMSWORTH	ZEE AD JDX GD	(ASSOC)	219
527	ANNE WARREN	KANEKY ROYAL EDITION ADM ADO GD SD JDX JDO SPD	(TERRIER (MAN))	220
526	RENEE PATTEN	T CH WILLIAM THEBLOODY CDX ET ADM JDM ADO JDO SDM GDX SPD DWDFM HTMN RN	(ASSOC)	221
525	JANINE FEIL	PADDINGTON CDX ADX JDX RN	(ASSOC)	222
519	VANESSA LOUGHLIN	MAGPIELANE SIGHING WIND CD ADM ADO3 JDM JDO4 GD SPD SD	(NSDTR)	223
518	K K KISIELNICKI	AG CH 500 KAYLADENE BORN TO RUN JDM ADM JDO ADO SPD	(BC)	224
513	G KISIELNICKI	AG CH GUIRMERE JAZZ ADM JDM ADO JDO SPD GDX SD	(BC)	225
512	MR G MRS J MILNER	AG CH YEOVILLE ACCIDENTAL HERO ADM JDM ADO JDO GDM SDM SPDM CD HSAS	(BC)	226
511	JULIE LYON	ALBAJAIL EMBRACE THE RACE ADX JDX	(AUSSIE)	227
506	PATRICIA ATTARD PAUL WARD	HOLLY GOLIGHTLY ADM JDM JDO ADO SPMD	(ASSOC)	228
505	KATE DALL	TJUKURPA WILLOW AD JDM	(KOOLIE)	229
502	STEPHEN PEARSON	FIDELS IN HOT PURSUIT ADX JDX	(BC)	230
501	JESS HARMSWORTH	DARCY DIVA CDX ADM JDM ADO JDO GDX SD	(ASSOC)	231
400				
421	LUKE WILBY	ELSPAN BARKLY BLUE ADX JDX	(COCKER)	232
416	M A SCHNIDER	MONTULATA JADES GEM CCD ADX JDX SD GD SPD	(BC)	233
415	MR SCOTT FLETCHER	JEOLENA BOY CANNY GO ADM ADO GDX JDM JDO SPDX SDX	(STAFFIE)	234

407	VANESSA LOUGHLIN	GLENMAVE CHAIN REACTION ADM JDX	(NSDTR)	235
406	MR E. R. FLETCHER	DEGUMLY CRICLIAM ADX JDX	(POODLE (MIN))	236
405	S. T. OBRIEN	DEBONAIR DARCY ADM ADO JDM JDO SPDM GD	(ASSOC)	237
300				
312	MR E. R. FLETCHER	DEGUMLY SWEET MUSIC ADX JDX	(POODLE (MIN))	238
309	MS MICHELE MOORE	TOONEYBANK STOPYA NAGGN ADX JDM SDX GD SPD	(SHELTIE)	239
305	SHARON MULSHINE	BINDI CD ADM ADO2 JDM JDO2 SD GD	(IGGY)	240
304	MR E. R. FLETCHER	DEGUMLY NIKITA ROSE ADX JDX	(POODLE (MIN))	241
303	S. T. OBRIEN	HENDERCHIP KICKNUP DUST JDM JDO ADX	(POODLE (TOY))	242
301	VICKI JOSEPHS	SUMMASTORM JDX AD SDX SPDX GD CCD	(TERRIER)	243
200				
202	KYLEY CONDER	CHEZJOLIE FANCY STUFF CCD JDX AD RN	(POODLE (TOY))	244
201	TAMMY BEATTIE	MADDOGMADISON AD JDX	(ASSOC)	245

Excellent Jumping (B) - Murray Tyler

Saturday 9th March, 2013 (AM)

600				
626	MALCOLM BIRD	BROOKSVALE LEICA AD JD	(BELGIAN)	246
616	FIONA COLENZO	CH ABBIESTAR MADE TO ORDER JD	(VIZSLA)	247
609	CAMILLA SLEETH	BLUEGRACE SEA CALLING AD JD	(PWD)	248
604	FIONA COLENZO	ABBIESTAR SPECIALIZED JD	(VIZSLA)	249
500				
577	KATIE BUGEJA	BLACKDIAMONDTOBY AD JD	(ASSOC)	250
574	SARAH MCDOWELL	ZAC JD	(BC)	251
572	PAULINE GARDNER	DALLAS GARDNER AD JD	(ASSOC)	252
564	LEIGH STRETTON	ASHA (JD)	(BC)	253
557	MRS EMI HINAGO MR DEAN CROSTHWAITE	SEAMIST KIARA JD	(BC)	254
553	MRS EMI HINAGO MR DEAN CROSTHWAITE	GUIRMERE BLUEMOON NIAH JD AD	(BC)	255
549	KATE SCOTT	BELADELE XTREME XCESS JD	(BC)	256
536	STEPHEN PEARSON	ICEANA MERCURY RISEN ET AD JD SPD	(VIZSLA)	257
524	MRS K MR G TAYLOR	NGALLA ONE OF THESE NIGHTS RN AD JD	(AUSSIE)	258
514	STEVE AND TERRI ROSE	KADNOOK BLAZE OF GLORY ADX JD	(LAB)	259
400				
419	MRS M HOLCOMBE	TEALC JD	(ASSOC)	260

409	MRS K MR G TAYLOR	SILVANWOOD HELLS BELLS RN JD	(AUSSIE)	261
401	VICKI JOSEPHS	DEMON AD JD SPD SD RN	(POODLE (MIN))	262
Open Jumping (B) - Murray Tyler		Saturday 9th March, 2013 (AM)		
600				
613	GARY STOCKMAN	KIWI MATAI JDX AD	(ASSOC)	263
605	STEVE AND TERRI ROSE	KADNOOK GROUSES LEGEND ADM JDX	(LAB)	264
603	DR J M MAGAREY	FLYNN JDX ADX SPD SDX GD	(BC)	265
500				
575	SANDY STOCKMAN	JETI KNIGHT JDX ADX GD	(KELPIE)	266
574	SARAH MCDOWELL	ZAC JD	(BC)	267
567	MEREDITH MARSHALL	MACZE JDX ADX SPD SD GD	(ASSOC)	268
564	LEIGH STRETTON	ASHA (JD)	(BC)	269
556	MS TRICIA DUNLOP	SASSYBRAT JDX AD	(BC)	270
552	SARAH CROCKER	MACDONALD AD JDX SPD	(ASSOC)	271
532	HEATHER DONALDSON	RICKY DONALDSON ADX JDM	(ASSOC)	272
527	ANNE WARREN	KANEKY ROYAL EDITION ADM ADO GD SD JDX JDO SPD	(TERRIER (MAN))	273
525	JANINE FEIL	PADDINGTON CDX ADX JDX RN	(ASSOC)	274
400				
412	MRS H M EAVES	RICOCHÉZ DYFRI LILI RHOSLYN TDX	(WELSHIE)	275
411	TINA CHESWORTH	ALCLUTHA KILTS A FLYIN ADM JDX GD SPDX ADO SD	(SHELTIE)	276
408	SHARON MULSHINE	LUCY ADM ADO5 JDX JDO3 SD SPD	(IGGY)	277
Novice Jumping (B) - Murray Tyler		Saturday 9th March, 2013 (AM)		
600				
621	MR M HOLCOMBE	PAIGE	(ASSOC)	278
618	PETER MARMO	ROZATE THE SEA HAWK	(AUSSIE)	279
615	SUSAN KERWIN	ALANGLÉN KEEP THE FAITH CDX ET	(LAB)	280
500				
578	NECIA LYNCH	DUAL CH TRACKING DEELEE BAMBINI BERNARDO CCD RN	(LAGOTTO)	281
573	K K KISIELNICKI	KAYLADENE IGNITE MY FIRE	(BC)	282
565	ELAINE RAWILLER	COOPERRAWILLER	(ASSOC)	283
563	SARAH GREENSTREET	AMAZINGGRACIE	(ASSOC)	284
559	G KISIELNICKI	KAYLADENE ROXYZ LIL ROCKET	(BC)	285
548	MRS K MR G TAYLOR	AUSSIE MIA RN	(ASSOC)	286

529	MRS ROSALINE TWAITES DR R ATYEO	YEOVILLE MISS INDEPENDENT HT	(BC)	287
528	VIVIAN O GRADY	MATILDAOGRADY	(ASSOC)	288
509	MS KIERSTEN COULTER	COMEBY MORE THAN ME	(AUSSIE)	289
508	LAURA DISTEFANO	ELLAGANT NEW VENTURE AD HT	(AUSSIE)	290
507	DR J M MAGAREY	GUIRMERE SCOUT GDSPDADSD	(BC)	291
400				
414	SALLY BURGESS	OLIVERJAMES RN	(ASSOC)	292
412	MRS H M EAVES	RICOCHÉZ DYFRI LILI RHOSLYN TDX	(WELSHIE)	293
300				
311	VICKI JOSEPHS	GLORI	(TERRIER)	294
308	MRS ANITA TILEY	AKIRA	(ASSOC)	295



SATURDAY PM

Open -Mr Murray Tyler Saturday 9th March, 2013 (PM)

O201	ANNE MANN	KOMBINALONG SUPER SAPPHIRA CD RN	ASSOCIATE	B	430
O202	ASHAMBER KENNELS	ASHAMBER LK WHS TALKIN CD RA	GOLDEN RETRIEVER	D	590
O203	CHRIS WITTICK	GRAND CH HANAFOR BARETT BAILEY CD	HUNGARIAN VIZSLA	D	600
O204	LIZ SHARP	GRAEBROOK NO PEEKING CD	HUNGARIAN VIZSLA	B	540
O205	SHAUN GENTLE	MILAMGIMBI LILAC TWIST CD	BORDER COLLIE	D	510
O206	DAWN GLANVILLE	JENUIN NINA SIMONE CD RE ADM JDX SD	POODLE (MINIATURE)	B	350

CDX	1 ST	SCORE
CDX	2 ND	SCORE
CDX	3 RD	SCORE

Novice -Mr Murray Tyler Saturday 9th March, 2013 (PM)

O207	MRS P SCOTT	CH FLYNTAHN MERCEDES	GERMAN SHORTHAired POINTER	B
O208	MS KIERSTEN COULTER	NGALLA WISH UPON A STAR	AUSTRALIAN SHEPHERD	B
O209	SUSAN KERWIN	MATAGANAH SAPPHIRE MOON	LABRADOR RETRIEVER	N

CD	1 ST	SCORE
CD	2 ND	SCORE
CD	3 RD	SCORE

Community Companion Dog -Mr Murray Tyler Saturday 9th March, 2013 (PM)

O210	I. IRWIN	RASTI	ASSOCIATE	D
O211	KAREN KELLY HOURTICOLON	BRANDYMUZZA	ASSOCIATE	B
O212	KATHRYN HOLE	LYNSLINE BLUE JASPER	SHETLAND SHEEPDOG	D
O213	LOIS DOEVEN	OSCAR WILD	ASSOCIATE AUSTRALIAN	N
O214	MR ROSS CARLSON	CH ELLAGANT TOP GUN RN	SHEPHERD	D
O215	LISA MAREE FRY	ERNIE	ASSOCIATE	D
O216	MR GRAHAM A . WILKINSON	SEAMUS WILKINSON	ASSOCIATE	D
O217	MS D M JAMES D L RAE	CH ARANYBAJNOK HUNT MASTER ET	HUNGARIAN VIZSLA	D
O218	CASSANDRA COLBERT	IRISHCLAN TOTAL ECLIPSE	COCKER SPANIEL	S

CCD	1 ST	SCORE
CCD	2 ND	SCORE
CCD	3 RD	SCORE

Utility - Mr Clive Makepeace Saturday 9th March, 2013 (PM)

O219	REBECCA MCGROARTY	HEVNSENT SWEET BABYBLU CDX	AUSTRALIAN SHEPHERD	B	500
O220	ANNE MANN	ZOE UD RE TD ET	ASSOCIATE	B	470
O221	HJ RK DIAMOND	NOONBARRA BOB II UD ADM ADO JDM SPD	AUSTRALIAN KELPIE	D	500
O222	LIZ SHARP	HUBERTUS IRESISTIBLE ISH CDX	HUNGARIAN VIZSLA	B	610
O223	RON SCIBERRAS	SPRITZEE INFLIGHT CDX	SCHNAUZER (MIN.)	D	350
O224	ADRIAN AND RANA BROGAN	JAMARANG BISKIT BROGAN CDX ET RA TCH AUSSIELAB MIDSUMMERDREAM CDX	GOLDEN RETRIEVER	D	600
O225	ASHAMBER KENNELS	JD RE	LABRADOR RETRIEVER	B	530

UD	1 ST	SCORE
UD	2 ND	SCORE
UD	3 RD	SCORE



300				
303	S. T. O'BRIEN	HENDERCHIP KICKNUP DUST JDM JDO ADX	(POODLE (TOY))	296
305	SHARON MULSHINE	BINDI CD ADM ADO2 JDM JDO2 SD GD	(IGGY)	297
309	MS MICHELE MOORE	TOONEYBANK STOPYA NAGGN ADX JDM SDX GD SPD	(SHELTIE)	298
400				
403	CAROLE DENEHEY	PHINEAS FOGG JDM ADM GD SDX SPDM JDO ADO TD FMX	(ASSOC)	299
406	MR E. R. FLETCHER	DEGUMLY CRICLIAM ADX JDX	(POODLE (MIN))	300
407	VANESSA LOUGHLIN	GLENMAVE CHAIN REACTION ADM JDX	(NSDTR)	301
408	SHARON MULSHINE	LUCY ADM ADO5 JDX JDO3 SD SPD	(IGGY)	302
411	TINA CHESWORTH	ALCLUTHA KILTS A FLYIN ADM JDX GD SPDX ADO SD	(SHELTIE)	303
413	SUE GONELLI	LEAPIN LEXIE ADM JDM SPDX GD SD	(ASSOC)	304
415	MR SCOTT FLETCHER	JEOLENA BOY CANNY GO ADM ADO GDX JDM JDO SPDX SDX	(STAFFIE)	305
416	M A SCHNIDER	MONTULATA JADES GEM CCD ADX JDX SD GD SPD	(BC)	306
418	HJ RK DIAMOND	HOLLYBRIT SHARP ASA TACK ADM JDM6 SPDX GD	(POODLE (MIN))	307
421	LUKE WILBY	ELSPAN BARKLY BLUE ADX JDX	(COCKER)	308
500				
502	STEPHEN PEARSON	FIDELS IN HOT PURSUIT ADX JDX	(BC)	309
511	JULIE LYON	ALBAJAIL EMBRACE THE RACE ADX JDX	(AUSSIE)	310
512	MR G MRS J MILNER	AG CH YEOVILLE ACCIDENTAL HERO ADM JDM ADO JDO GDM SDM SPDM CD HSAS	(BC)	311
513	G KISIELNICKI	AG CH GUIRMERE JAZZ ADM JDM ADO JDO SPD GDX SD	(BC)	312
514	STEVE AND TERRI ROSE	KADNOOK BLAZE OF GLORY ADX JD	(LAB)	313
518	K K KISIELNICKI	AG CH 500 KAYLADENE BORN TO RUN JDM ADM JDO ADO SPD	(BC)	314
519	VANESSA LOUGHLIN	MAGPIELANE SIGHING WIND CD ADM ADO3 JDM JDO4 GD SPD SD	(NSDTR)	315
525	JANINE FEIL	PADDINGTON CDX ADX JDX RN	(ASSOC)	316
526	RENEE PATTEN	T CH WILLIAM THEBLOODY CDX ET ADM JDM ADO JDO SDM GDX SPDX DWDFH HTMN RN	(ASSOC)	317
527	ANNE WARREN	KANEKY ROYAL EDITION ADM ADO GD SD JDX JDO SPD	(TERRIER (MAN))	318
532	HEATHER DONALDSON	RICKY DONALDSON ADX JDM	(ASSOC)	319
541	JULIE LYON ANA RICHARDSON	ELLAGANT ITS IN THE GENES ADX JDO JDM2 SPD GDX	(AUSSIE)	320

543	G KISIELNICKI	AG CH KAYLADENE CHOC ROYAL ADM JDM ADO JDO SPDM GDX SDG	(BC)	321
546	K K KISIELNICKI	AG CH KAYLADENE TRIPLE CHOC ADM JDM ADO JDO SPDM GDX SDX	(BC)	322
551	KERRIE L RYAN	BAILEY GIRL ADM JDM	(ASSOC)	323
554	R FAGAN	MACYS MYSTIC BLUE SAPPHIRE ADM JDM ADO JDO CD FM	(AUSSIE)	324
561	K K KISIELNICKI	HILLCREST JUMPIN JIVE (IMP USA) JDM ADM	(BC)	325
567	MEREDITH MARSHALL	MACZE JDX ADX SPD SD GD	(ASSOC)	326
568	MEGAN SEMPLE	T CH ALANGLN JINDABYNE ROSE CCD ADM JDM SDX SPDX ET	(LAB)	327
569	JULIE LYON	SHEP ALIAN DREAMS UNWIND ADM ADO JDM JDO GD SD SPD (IMP UK)	(AUSSIE)	328
575	SANDY STOCKMAN	JETI KNIGHT JDX ADX GD	(KELPIE)	329
576	MRS SL AND MR AC SANDERSON	ALANGLN ARWEN ROSE CD ADM ADO JDM JDO SD SPDX GDX	(LAB)	330
600				
603	DR J M MAGAREY	FLYNN JDX ADX SPD SDX GD	(BC)	331
605	STEVE AND TERRI ROSE	KADNOOK GROUSES LEGEND ADM JDX	(LAB)	332
607	L K HAMMER AND K A EDWARDS	FENIK LIQUORICE ALSPORT ADM2 ADO JDM JDO SDX GDX SPDM	(GSP)	333
611	MRS JENNY WILLIAMS	ROBBIE JAY ADX ADO JDO JDM	(ASSOC)	334
617	L K HAMMER AND K A EDWARDS	FENRIK MURPHYS OUTLAW ADM3 ADO3 JDM6 JFO4 SDM GDM SPDM	(GSP)	335
619	MICHAEL CHESWORTH	KAYLADENE TAKE IT EASY ADX JDX SPD	(BC)	336
622	MIKA PEACE	DYKINTA RED ALERT ADM JDM ADO JDO GDX SD SPD	(AUSSIE)	337
625	L K HAMMER AND K A EDWARDS	PACE VON DER MADLAGE (IMP DEU) ADX ADO JDX SD GD SPDX	(GSP)	338

Excellent Agility (C) - Roger Padfield

Saturday 9th March, 2013 (PM)

200				
201	TAMMY BEATTIE	MADDOGMADISON AD JDX	(ASSOC)	339
202	KYLEY CONDER	CHEZJOLIE FANCY STUFF CCD JDX AD RN	(POODLE (TOY))	340
300				
301	VICKI JOSEPHS	SUMMASTORM JDX AD SDX SPDX GD CCD	(TERRIER)	341
304	MR E. R. FLETCHER	DEGUMLY NIKITA ROSE ADX JDX	(POODLE (MIN))	342
312	MR E. R. FLETCHER	DEGUMLY SWEET MUSIC ADX JDX	(POODLE (MIN))	343

400

401	VICKI JOSEPHS	DEMON AD JD SPD SD RN	(POODLE (MIN))	344
500				
505	KATE DALL	TJUKURPA WILLOW AD JDM	(KOOLIE)	345
507	DR J M MAGAREY	GUIRMERE SCOUT GDSPDADSD	(BC)	346
508	LAURA DISTEFANO	ELLAGANT NEW VENTURE AD HT	(AUSSIE)	347
522	LINDENBRAE KENNELS	LINDENBRAE TARFIN FEY CONJURER CCD RN JD AD	(BC)	348
535	JESS HARMSWORTH	ZEE AD JDX GD	(ASSOC)	349
536	STEPHEN PEARSON	ICEANA MERCURY RISEN ET AD JD SPD	(VIZSLA)	350
544	J. LEWIS L. LLOYD	GWAERFEYN IVY AD JDX	(BC)	351
552	SARAH CROCKER	MACDONALD AD JDX SPD	(ASSOC)	352
555	LYNN MUSSETT	PORUSE DUALY BUILT CD JDX AD RN	(AUSSIE)	353
558	MR GARRY C HEINZE	BILLYDOGHEINZE AD JDX	(ASSOC)	354
564	LEIGH STRETTON	ASHA (JD)	(BC)	355
572	PAULINE GARDNER	DALLAS GARDNER AD JD	(ASSOC)	356
577	KATIE BUGEJA	BLACKDIAMONDTOBY AD JD	(ASSOC)	357
600				
602	KATE DALL	TJUKURPA TRAPPER AD JDX	(KOOLIE)	358
613	GARY STOCKMAN	KIWI MATAI JDX AD	(ASSOC)	359

Novice Agility (C) - Roger Padfield

Saturday 9th March, 2013 (PM)

400				
409	MRS K MR G TAYLOR	SILVANWOOD HELLS BELLS RN JD	(AUSSIE)	360
412	MRS H M EAVES	RICOCHAZ DYFRI LILI RHOSLYN TDX	(WELSHIE)	361
414	SALLY BURGESS	OLIVERJAMES RN	(ASSOC)	362
417	BEL ADELE KENNELS / ANGIE GUNTHER	BEL ADELE XTREME XTACY CCD JDX	(BC)	363
419	MRS M HOLCOMBE	TEALC JD	(ASSOC)	364
500				
509	MS KIERSTEN COULTER	COMEBY MORE THAN ME	(AUSSIE)	365
529	MRS ROSALINE TWAITES DR R ATYEO	YEOVILLE MISS INDEPENDENT HT	(BC)	366
549	KATE SCOTT	BELADELE XTREME XCESS JD	(BC)	367
559	G KISIELNICKI	KAYLADENE ROXYZ LIL ROCKET	(BC)	368
563	SARAH GREENSTREET	AMAZINGGRACIE	(ASSOC)	369
566	MRS M J CORRY-THOMAS	SHANOWL QUIZA WHIZZ SPICE	(BC)	370
573	K K KISIELNICKI	KAYLADENE IGNITE MY FIRE	(BC)	371
574	SARAH MCDOWELL	ZAC JD	(BC)	372
600				
615	SUSAN KERWIN	ALANGLEN KEEP THE FAITH CDX ET	(LAB)	373

618	PETER MARMO	ROZATE THE SEA HAWK	(AUSSIE)	374
621	MR M HOLCOMBE	PAIGE	(ASSOC)	375
623	ADRIAN AND RANA BROGAN	JAMARANG BISKIT BROGAN CDX ET RA	(GOLDIE)	376

Excellent Jumping (C) - Adrian Tilley

Saturday 9th March, 2013 (PM)

600				
626	MALCOLM BIRD	BROOKSVALE LEICA AD JD	(BELGIAN)	430
608	MRS K MR G TAYLOR	AUSSIE BUNDY CCD RN JD	(ASSOC)	431
604	FIONA COLENZO	ABBIESTAR SPECIALIZED JD	(VIZSLA)	432
500				
577	KATIE BUGEJA	BLACKDIAMONDTOPY AD JD	(ASSOC)	433
574	SARAH MCDOWELL	ZAC JD	(BC)	434
572	PAULINE GARDNER	DALLAS GARDNER AD JD	(ASSOC)	435
564	LEIGH STRETTON	ASHA (JD)	(BC)	436
557	MRS EMI HINAGO MR DEAN CROSTHWAITE	SEAMIST KIARA JD	(BC)	437
553	MRS EMI HINAGO MR DEAN CROSTHWAITE	GUIRMERE BLUEMOON NIAH JD AD	(BC)	438
549	KATE SCOTT	BELADELE XTREME XCESS JD	(BC)	439
524	MRS K MR G TAYLOR	NGALLA ONE OF THESE NIGHTS RN AD JD	(AUSSIE)	440
522	LINDENBRAE KENNELS	LINDENBRAE TARFIN FEY CONJURER CCD RN JD AD	(BC)	441
514	STEVE AND TERRI ROSE	KADNOOK BLAZE OF GLORY ADX JD	(LAB)	442
400				
419	MRS M HOLCOMBE	TEALC JD	(ASSOC)	443
409	MRS K MR G TAYLOR	SILVANWOOD HELLS BELLS RN JD	(AUSSIE)	444

Masters Jumping (C) - Adrian Tilley

Saturday 9th March, 2013 (PM)

600				
622	MIKA PEACE	DYKINTA RED ALERT ADM JDM ADO JDO GDX SD SPD	(AUSSIE)	377
619	MICHAEL CHESWORTH	KAYLADENE TAKE IT EASY ADX JDX SPD	(BC)	378
617	L K HAMMER AND K A EDWARDS	FENRIK MURPHYS OUTLAW ADM3 ADO3 JDM6 JFO4 SDM GDM SPDM	(GSP)	379
613	GARY STOCKMAN	KIWI MATAI JDX AD	(ASSOC)	380
612	R L PADFIELD	JAZPA CD ADX JDX JDO ADO SPD	(ASSOC)	381
603	DR J M MAGAREY	FLYNN JDX ADX SPD SDX GD	(BC)	382
602	KATE DALL	TJUKURPA TRAPPER AD JDX	(KOOLIE)	383

500

576	MRS SL AND MR AC SANDERSON	ALANGLLEN ARWEN ROSE CD ADM ADO JDM JDO SD SPDX GDX	(LAB)	384
575	SANDY STOCKMAN	JETI KNIGHT JDX ADX GD	(KELPIE)	385
571	BELINDA TEBBET	DARGO TEBBET AD JDX SD ET	(ASSOC)	386
569	JULIE LYON	SHEPALIAN DREAMS UNWIND ADM ADO JDM JDO GD SD SPD (IMP UK)	(AUSSIE)	387
568	MEGAN SEMPLE	T CH ALANGLLEN JINDABYNE ROSE CCD ADM JDM SDX SPDX ET	(LAB)	388
567	MEREDITH MARSHALL	MACZE JDX ADX SPD SD GD	(ASSOC)	389
561	K K KISIELNICKI	HILLCREST JUMPIN JIVE (IMP USA) JDM ADM	(BC)	390
556	MS TRICIA DUNLOP	SASSYBRAT JDX AD	(BC)	391
555	LYNN MUSSETT	PORUSE DUALLY BUILT CD JDX AD RN	(AUSSIE)	392
554	R FAGAN	MACYS MYSTIC BLUE SAPPHIRE ADM JDM ADO JDO CD FM	(AUSSIE)	393
552	SARAH CROCKER	MACDONALD AD JDX SPD	(ASSOC)	394
551	KERRIE L RYAN	BAILEY GIRL ADM JDM	(ASSOC)	395
546	K K KISIELNICKI	AG CH KAYLADENE TRIPLE CHOC ADM JDM ADO JDO SPDM GDX SDX	(BC)	396
544	J. LEWIS L. LLOYD	GWAERFEYN IVY AD JDX	(BC)	397
543	G KISIELNICKI	AG CH KAYLADENE CHOC ROYAL ADM JDM ADO JDO SPDM GDX SDG	(BC)	398
542	MR G MRS J MILNER	GUIRMERE RUM RUNNER JDX HT	(BC)	399
541	JULIE LYON ANA RICHARDSON	ELLAGANT ITS IN THE GENES ADX JDO JDM2 SPD GDX	(AUSSIE)	400
538	PATRICIA ATTARD PAUL WARD	SCOUTS HONOUR AD JDM	(ASSOC)	401
537	REBEKAH FOORD	MACYS MINIATURE PATCHES CDADO7ADM4JDM6JDO5GDSPXFDM	(AUSSIE)	402
532	HEATHER DONALDSON	RICKY DONALDSON ADX JDM	(ASSOC)	403
526	RENEE PATTEN	T CH WILLIAM THEBLOODY CDX ET ADM JDM ADO JDO SDM GDX SPDX DWDFH HTMN RN	(ASSOC)	404
525	JANINE FEIL	PADDINGTON CDX ADX JDX RN	(ASSOC)	405
519	VANESSA LOUGHLIN	MAGPIELANE SIGHING WIND CD ADM ADO3 JDM JDO4 GD SPD SD	(NSDTR)	406
518	K K KISIELNICKI	AG CH 500 KAYLADENE BORN TO RUN JDM ADM JDO ADO SPD	(BC)	407
513	G KISIELNICKI	AG CH GUIRMERE JAZZ ADM JDM ADO JDO SPD GDX SD	(BC)	408
512	MR G MRS J MILNER	AG CH YEOVILLE ACCIDENTAL HERO ADM JDM ADO JDO GDM SDM SPDM CD HSAS	(BC)	409
511	JULIE LYON	ALBAJAIL EMBRACE THE RACE ADX JDX	(AUSSIE)	410
506	PATRICIA ATTARD PAUL WARD	HOLLY GOLIGHTLY ADM JDM JDO ADO SPMD	(ASSOC)	411
505	KATE DALL	TJUKURPA WILLOW AD JDM	(KOOLIE)	412
501	JESS HARMSWORTH	DARCY DIVA CDX ADM JDM ADO JDO GDX SD	(ASSOC)	413
400				
421	LUKE WILBY	ELSPAN BARKLY BLUE ADX JDX	(COCKER)	414

417	BEL ADELE KENNELS / ANGIE GUNTHER	BEL ADELE XTREME XTACY CCD JDX	(BC)	415
416	M A SCHNIDER	MONTULATA JADES GEM CCD ADX JDX SD GD SPD	(BC)	416
415	MR SCOTT FLETCHER	JEOLENA BOY CANNY GO ADM ADO GDX JDM JDO SPDX SDX	(STAFFIE)	417
413	SUE GONELLI	LEAPIN LEXIE ADM JDM SPDX GD SD	(ASSOC)	418
407	VANESSA LOUGHLIN	GLENMAVE CHAIN REACTION ADM JDX	(NSDTR)	419
405	S. T. OBRIEN	DEBONAIR DARCY ADM ADO JDM JDO SPDM GD	(ASSOC)	420
404	LAURA DISTEFANO	AG CH 400 NELLIE GIRL ADM ADO JDM JDO HT PT GD	(ASSOC)	421
402	BEL ADELE KENNELS / ANGIE GUNTHER	BEL ADELE UR UNIQUE. CDX AD JDX	(BC)	422
300				
309	MS MICHELE MOORE	TOONEYBANK STOPYA NAGGN ADX JDM SDX GD SPD	(SHELTIE)	423
307	DAWN GLANVILLE	JENUIN NINA SIMONE CD RE ADM JDX SD	(POODLE (MIN))	424
305	SHARON MULSHINE	BINDI CD ADM ADO2 JDM JDO2 SD GD	(IGGY)	425
303	S. T. OBRIEN	HENDERCHIP KICKNUP DUST JDM JDO ADX	(POODLE (TOY))	426
302	CAROLE DENEHEY	HENDERCHIP DARTAGNAN JDX FD	(POODLE (TOY))	427
200				
202	KYLEY CONDER	CHEZJOLIE FANCY STUFF CCD JDX AD RN	(POODLE (TOY))	428
201	TAMMY BEATTIE	MADDOGMADISON AD JDX	(ASSOC)	429

Novice Jumping (C) - Adrian Tilley

Saturday 9th March, 2013 (PM)

600				
618	PETER MARMO	ROZATE THE SEA HAWK	(AUSSIE)	445
615	SUSAN KERWIN	ALANGLLEN KEEP THE FAITH CDX ET	(LAB)	446
614	MS D M JAMES D L RAE	CH ARANYBAJNOK HUNT MASTER ET	(VIZSLA)	447
500				
573	K K KISIELNICKI	KAYLADENE IGNITE MY FIRE	(BC)	448
566	MRS M J CORRY-THOMAS	SHANOWL QUIZA WHIZZ SPICE	(BC)	449
565	ELAINE RAWILLER	COOPERRAWILLER	(ASSOC)	450
563	SARAH GREENSTREET	AMAZINGGRACIE	(ASSOC)	451
559	G KISIELNICKI	KAYLADENE ROXYZ LIL ROCKET	(BC)	452
548	MRS K MR G TAYLOR	AUSSIE MIA RN	(ASSOC)	453
531	JOHN FULTON	KELLYNOTGEMMA	(ASSOC)	454

529	MRS ROSALINE TWAITES DR R ATYEO	YEOVILLE MISS INDEPENDENT HT	(BC)	455
509	MS KIERSTEN COULTER	COMEBY MORE THAN ME	(AUSSIE)	456
507	DR J M MAGAREY	GUIRMERE SCOUT GDSPDADSD	(BC)	457
400				
412	MRS H M EAVES	RICOCHERZ DYFRI LILI RHOSLYN TDX	(WELSHIE)	458
300				
313	TINA CHESWORTH	YACKAWIL YESTERDAYS DREAM	(SHELTIE)	459
311	VICKI JOSEPHS	GLORI	(TERRIER)	460

Novice Jumping (D) - Ray Ashman

Saturday 9th March, 2013 (PM)

600				
621	MR M HOLCOMBE	PAIGE	(ASSOC)	461
618	PETER MARMO	ROZATE THE SEA HAWK	(AUSSIE)	462
615	SUSAN KERWIN	ALANGLLEN KEEP THE FAITH CDX ET	(LAB)	463
500				
573	K K KISIELNICKI	KAYLADENE IGNITE MY FIRE	(BC)	464
563	SARAH GREENSTREET	AMAZINGGRACIE	(ASSOC)	465
559	G KISIELNICKI	KAYLADENE ROXYZ LIL ROCKET	(BC)	466
531	JOHN FULTON	KELLYNOTGEMMA	(ASSOC)	467
529	MRS ROSALINE TWAITES DR R ATYEO	YEOVILLE MISS INDEPENDENT HT	(BC)	468
509	MS KIERSTEN COULTER	COMEBY MORE THAN ME	(AUSSIE)	469
507	DR J M MAGAREY	GUIRMERE SCOUT GDSPDADSD	(BC)	470
400				
414	SALLY BURGESS	OLIVERJAMES RN	(ASSOC)	471
412	MRS H M EAVES	RICOCHERZ DYFRI LILI RHOSLYN TDX	(WELSHIE)	472
300				
311	VICKI JOSEPHS	GLORI	(TERRIER)	473
308	MRS ANITA TILEY	AKIRA	(ASSOC)	474

Excellent Jumping (D) - Ray Ashman**Saturday 9th March, 2013 (PM)**

600				
608	MRS K MR G TAYLOR	AUSSIE BUNDY CCD RN JD	(ASSOC)	475
604	FIONA COLENZO	ABBIESTAR SPECIALIZED JD	(VIZSLA)	476
500				
577	KATIE BUGEJA	BLACKDIAMONDTOPY AD JD	(ASSOC)	477
574	SARAH MCDOWELL	ZAC JD	(BC)	478
572	PAULINE GARDNER	DALLAS GARDNER AD JD	(ASSOC)	479
564	LEIGH STRETTON	ASHA (JD)	(BC)	480
557	MRS EMI HINAGO MR DEAN CROSTHWAITE	SEAMIST KIARA JD	(BC)	481
553	MRS EMI HINAGO MR DEAN CROSTHWAITE	GUIRMERE BLUEMOON NIAH JD AD	(BC)	482
549	KATE SCOTT	BELADELE XTREME XCESS JD	(BC)	483
536	STEPHEN PEARSON	ICEANA MERCURY RISEN ET AD JD SPD	(VIZSLA)	484
524	MRS K MR G TAYLOR	NGALLA ONE OF THESE NIGHTS RN AD JD	(AUSSIE)	485
522	LINDENBRAE KENNELS	LINDENBRAE TARFIN FEY CONJURER CCD RN JD AD	(BC)	486
514	STEVE AND TERRI ROSE	KADNOOK BLAZE OF GLORY ADX JD	(LAB)	487

Masters Jumping (D) - Ray Ashman**Saturday 9th March, 2013 (PM)**

600				
625	L K HAMMER AND K A EDWARDS	PACE VON DER MADLAGE (IMP DEU) ADX ADO JDX SD GD SPDX	(GSP)	488
622	MIKA PEACE	DYKINTA RED ALERT ADM JDM ADO JDO GDX SD SPD	(AUSSIE)	489
619	MICHAEL CHESWORTH	KAYLADENE TAKE IT EASY ADX JDX SPD	(BC)	490
613	GARY STOCKMAN	KIWI MATAI JDX AD	(ASSOC)	491
611	MRS JENNY WILLIAMS	ROBBIE JAY ADX ADO JDO JDM	(ASSOC)	492
607	L K HAMMER AND K A EDWARDS	FENIK LIQUORICE ALSPORT ADM2 ADO JDM JDO SDX GDX SPDM	(GSP)	493
605	STEVE AND TERRI ROSE	KADNOOK GROUSES LEGEND ADM JDX	(LAB)	494
603	DR J M MAGAREY	FLYNN JDX ADX SPD SDX GD	(BC)	495
602	KATE DALL	TJUKURPA TRAPPER AD JDX	(KOOLIE)	496
500				
576	MRS SL AND MR AC SANDERSON	ALANGLEN ARWEN ROSE CD ADM ADO JDM JDO SD SPDX GDX	(LAB)	497
575	SANDY STOCKMAN	JETI KNIGHT JDX ADX GD	(KELPIE)	498
571	BELINDA TEBBET	DARGO TEBBET AD JDX SD ET	(ASSOC)	499
569	JULIE LYON	SHEPALIAN DREAMS UNWIND ADM ADO JDM JDO GD SD SPD (IMP UK)	(AUSSIE)	500

568	MEGAN SEMPLE	T CH ALANGLLEN JINDABYNE ROSE CCD ADM JDM SDX SPD ET	(LAB)	501
567	MEREDITH MARSHALL	MACZE JDX ADX SPD SD GD	(ASSOC)	502
561	K K KISIELNICKI	HILLCREST JUMPIN JIVE (IMP USA) JDM ADM	(BC)	503
558	MR GARRY C HEINZE	BILLYDOGHEINZE AD JDX	(ASSOC)	504
556	MS TRICIA DUNLOP	SASSYBRAT JDX AD	(BC)	505
555	LYNN MUSSETT	PORUSE DUALLY BUILT CD JDX AD RN	(AUSSIE)	506
554	R FAGAN	MACYS MYSTIC BLUE SAPPHIRE ADM JDM ADO JDO CD FM	(AUSSIE)	507
552	SARAH CROCKER	MACDONALD AD JDX SPD	(ASSOC)	508
551	KERRIE L RYAN	BAILEY GIRL ADM JDM	(ASSOC)	509
546	K K KISIELNICKI	AG CH KAYLADENE TRIPLE CHOC ADM JDM ADO JDO SPDM GDX SDX	(BC)	510
544	J. LEWIS L. LLOYD	GWAERFEYN IVY AD JDX	(BC)	511
543	G KISIELNICKI	AG CH KAYLADENE CHOC ROYAL ADM JDM ADO JDO SPDM GDX SDG	(BC)	512
542	MR G MRS J MILNER	GUIRMERE RUM RUNNER JDX HT	(BC)	513
541	JULIE LYON ANA RICHARDSON	ELLAGANT ITS IN THE GENES ADX JDO JDM2 SPD GDX	(AUSSIE)	514
538	PATRICIA ATTARD PAUL WARD	SCOUTS HONOUR AD JDM	(ASSOC)	515
537	REBEKAH FOORD	MACYS MINIATURE PATCHES CDADO7ADM4JDM6JDO5GDXSPXFD	(AUSSIE)	516
532	HEATHER DONALDSON	RICKY DONALDSON ADX JDM	(ASSOC)	517
527	ANNE WARREN	KANEKY ROYAL EDITION ADM ADO GD SD JDX JDO SPD	(TERRIER (MAN))	518
526	RENEE PATTEN	T CH WILLIAM THEBLOODY CDX ET ADM JDM ADO JDO SDM GDX SPD DWDFM HTMN RN	(ASSOC)	519
519	VANESSA LOUGHLIN	MAGPIELANE SIGHING WIND CD ADM ADO3 JDM JDO4 GD SPD SD	(NSDTR)	520
518	K K KISIELNICKI	AG CH 500 KAYLADENE BORN TO RUN JDM ADM JDO ADO SPD	(BC)	521
513	G KISIELNICKI	AG CH GUIRMERE JAZZ ADM JDM ADO JDO SPD GDX SD	(BC)	522
512	MR G MRS J MILNER	AG CH YEOVILLE ACCIDENTAL HERO ADM JDM ADO JDO GDM SDM SPDM CD HSAS	(BC)	523
511	JULIE LYON	ALBAJAIL EMBRACE THE RACE ADX JDX	(AUSSIE)	524
506	PATRICIA ATTARD PAUL WARD	HOLLY GOLIGHTLY ADM JDM JDO ADO SPMD	(ASSOC)	525
505	KATE DALL	TJUKURPA WILLOW AD JDM	(KOOLIE)	526
501	JESS HARMSWORTH	DARCY DIVA CDX ADM JDM ADO JDO GDX SD	(ASSOC)	527
400				
421	LUKE WILBY	ELSPAN BARKLY BLUE ADX JDX	(COCKER)	528
418	HJ RK DIAMOND	HOLLYBRIT SHARP ASA TACK ADM JDM6 SPD GD	(POODLE (MIN))	529
417	BEL ADELE KENNELS / ANGIE GUNTHER	BEL ADELE XTREME XTACY CCD JDX	(BC)	530
416	M A SCHNIDER	MONTULATA JADES GEM CCD ADX JDX SD GD SPD	(BC)	531

415	MR SCOTT FLETCHER	JEOLENA BOY CANNY GO ADM ADO GDX JDM JDO SPDX SDX	(STAFFIE)	532
407	VANESSA LOUGHLIN	GLENMAVE CHAIN REACTION ADM JDX	(NSDTR)	533
405	S. T. OBRIEN	DEBONAIR DARCY ADM ADO JDM JDO SPDM GD	(ASSOC)	534
402	BEL ADELE KENNELS / ANGIE GUNTHER	BEL ADELE UR UNIQUE. CDX AD JDX	(BC)	535
300				
309	MS MICHELE MOORE	TOONEYBANK STOPYA NAGGN ADX JDM SDX GD SPD	(SHELTIE)	536
307	DAWN GLANVILLE	JENUIN NINA SIMONE CD RE ADM JDX SD	(POODLE (MIN))	537
305	SHARON MULSHINE	BINDI CD ADM ADO2 JDM JDO2 SD GD	(IGGY)	538
303	S. T. OBRIEN	HENDERCHIP KICKNUP DUST JDM JDO ADX	(POODLE (TOY))	539
302	CAROLE DENEHEY	HENDERCHIP DARTAGNAN JDX FD	(POODLE (TOY))	540
200				
202	KYLEY CONDER	CHEZJOLIE FANCY STUFF CCD JDX AD RN	(POODLE (TOY))	541
201	TAMMY BEATTIE	MADDOGMADISON AD JDX	(ASSOC)	542

Open - Mrs Alison Rumble Sunday 10th March, 2013 (AM)

O301	ANNE MANN	KOMBINALONG SUPER SAPPHIRA CD RN	ASSOCIATE	B	430
O302	ASHAMBER KENNELS	ASHAMBER LK WHS TALKIN CD RA	GOLDEN RETRIEVER	D	590
O303	CHRIS WITTICK	GRAND CH HANAFOR BARETT BAILEY CD	HUNGARIAN VIZSLA	D	600
O304	LIZ SHARP	GRAEBROOK NO PEEKING CD	HUNGARIAN VIZSLA	B	540
O305	SHAUN GENTLE	MILAMGIMBI LILAC TWIST CD	BORDER COLLIE	D	510
O306	LINDENBRAE KENNELS	LINDENBRAE TARFIN DONNA	BORDER COLLIE	B	500
O307	LINDENBRAE KENNELS	LINDENBRAE TARFINELEKTRA	BORDER COLLIE	B	500
O308	DAWN GLANVILLE	JENUIN NINA SIMONE CD RE ADM JDX SD	POODLE (MINIATURE)	B	350

CDX	1 ST	SCORE
CDX	2 ND	SCORE
CDX	3 RD	SCORE

Novice - Mrs Alison Rumble Sunday 10th March, 2013 (AM)

O309	CASSANDRA COLBERT	NESSII CCD	ASSOCIATE	S
O310	MRS P SCOTT	CH FLYNTAHN MERCEDES	GERMAN SHORTHAIRED POINTER	B
O311	MS KIERSTEN COULTER	NGALLA WISH UPON A STAR	AUSTRALIAN SHEPHERD	B
O312	N HARRY	WINTERSET SHADES OFBLUE QND RN DUAL CH TRACKING DEELEE BAMBINI	GOLDEN RETRIEVER	B
O313	NECIA LYNCH	BERNARDO CCD RN	LAGOTTO ROMAGNOLO	D

CD	1 ST	SCORE
CD	2 ND	SCORE
CD	3 RD	SCORE

Community Companion Dog - Mrs Alison Rumble Sunday 10th March, 2013 (AM)

O314	ASHAMBER KENELS	CONINGSBURGH MAGICAL DIVA	LABRADOR RETRIEVER	B
O315	I IRWIN	RASTI	ASSOCIATE	D
O316	KAREN KELLY HOUTICOLON	BRANDYMUZZA	ASSOCIATE	B
O317	KATHRYN HOLE	LYNSLINE BLUE JASPER	SHELTLAND SHEEPDOG	D
O318	MR ROSS CARLSON	ELLAGANT TOP RUN RN	AUSTRALIAN SHEPHERD	D
O319	LISA MAREE FRY	ERNIE	ASSOCIATE	D
O320	MR GRAHAM A WILKINSON	SEAMUS WILKINSON	ASSOCIATE	
O321	MS D M JAMES D L RAE	ARANYBAJNOK HUNT MASTER ET	HUNGARIAN VIZSLA	
O322	CASSANDRA COLBERT	IRISHCLAN TOTAL ECLIPSE	COCKER SPANIEL	

CCD	1 ST	SCORE
CCD	2 ND	SCORE
CCD	3 RD	SCORE

Utility Dog Excellent - Mr Dave Rumble Sunday 10th March, 2013 (AM)

O323 MARTA MCKENZIE T.CH. YEOVILLE MASTERMINE UD ET RE BORDER COLLIE D 500

UDX	1 ST	SCORE
UDX	2 ND	SCORE
UDX	3 RD	SCORE

Utility - Mr Dave Rumble Sunday 10th March, 2013 (AM)

O324	REBECCA MCGROARTY	HEVNSSENT SWEET BABYBLU CDX	AUSTRALIAN SHEPHERD	B	500
O325	ANDREW MACDONALD	STEVIEJOSH TEUTONIC KNIGHT CDX TD ET	GERMAN SHEPHERD DOG	D	650
O326	ANNE MANN	ZOE UD RE TD ET	ASSOCIATE	B	470
O327	LIZ SHARP	HUBERTUS IRESISTIBLE ISH CDX	HUNGARIAN VIZSLA	B	610
O328	RON SCIBERRAS	SPRITZEE INFLIGHT CDX	SCHNAUZER (MIN.)	D	350
O329	ADRIAN AND RANA BROGAN	JAMARANG BISKIT BROGAN CDX ET RA TCH AUSSIELAB MIDSUMMERDREAM CDX	GOLDEN RETRIEVER	D	600
O330	ASHAMBER KENNELS	JD RE	LABRADOR RETRIEVER	B	530

UD	1 ST	SCORE
UD	2 ND	SCORE
UD	3 RD	SCORE

Novice Agility (E) - Ray Ashman**Sunday 10th March, 2013 (AM)**

300				
302	CAROLE DENEHEY	HENDERCHIP DARTAGNAN JDX FD	(POODLE (TOY))	543
400				
409	MRS K MR G TAYLOR	SILVANWOOD HELLS BELLS RN JD	(AUSSIE)	544
412	MRS H M EAVES	RICOCHERZ DYFRI LILI RHOSLYN TDX	(WELSHIE)	545
414	SALLY BURGESS	OLIVERJAMES RN	(ASSOC)	546
417	BEL ADELE KENNELS / ANGIE GUNTHER	BEL ADELE XTREME XTACY CCD JDX	(BC)	547
500				
509	MS KIERSTEN COULTER	COMEBY MORE THAN ME	(AUSSIE)	548
529	MRS ROSALINE TWAITES DR R ATYEO	YEOVILLE MISS INDEPENDENT HT	(BC)	549
542	MR G MRS J MILNER	GUIRMERE RUM RUNNER JDX HT	(BC)	550
549	KATE SCOTT	BELADELE XTREME XCESS JD	(BC)	551
559	G KISIELNICKI	KAYLADENE ROXYZ LIL ROCKET	(BC)	552
563	SARAH GREENSTREET	AMAZINGGRACIE	(ASSOC)	553
566	MRS M J CORRY-THOMAS	SHANOWL QUIZA WHIZZ SPICE	(BC)	554
573	K K KISIELNICKI	KAYLADENE IGNITE MY FIRE	(BC)	555
578	NECIA LYNCH	DUAL CH TRACKING DEELEEE BAMBINI BERNARDO CCD RN	(LAGOTTO)	556
600				
615	SUSAN KERWIN	ALANGLLEN KEEP THE FAITH CDX ET	(LAB)	557
618	PETER MARMO	ROZATE THE SEA HAWK	(AUSSIE)	558
623	ADRIAN AND RANA BROGAN	JAMARANG BISKIT BROGAN CDX ET RA	(GOLDIE)	559

Open Agility (E) - Ray Ashman**Sunday 10th March, 2013 (AM)**

400				
408	SHARON MULSHINE	LUCY ADM ADO5 JDX JDO3 SD SPD	(IGGY)	578
411	TINA CHESWORTH	ALCLUTHA KILTS A FLYIN ADM JDX GD SPDX ADO SD	(SHELTIE)	579
412	MRS H M EAVES	RICOCHERZ DYFRI LILI RHOSLYN TDX	(WELSHIE)	580
415	MR SCOTT FLETCHER	JEOLENA BOY CANNY GO ADM ADO GDX JDM JDO SPDX SDX	(STAFFIE)	581
416	M A SCHNIDER	MONTULATA JADES GEM CCD ADX JDX SD GD SPD	(BC)	582
421	LUKE WILBY	ELSPAN BARKLY BLUE ADX JDX	(COCKER)	583
500				

512	MR G MRS J MILNER	AG CH YEOVILLE ACCIDENTAL HERO ADM JDM ADO JDO GDM SDM SPDM CD HSAS	(BC)	584
525	JANINE FEIL	PADDINGTON CDX ADX JDX RN	(ASSOC)	585
527	ANNE WARREN	KANEKY ROYAL EDITION ADM ADO GD SD JDX JDO SPD	(TERRIER (MAN))	586
544	J. LEWIS L. LLOYD	GWAERFEYN IVY AD JDX	(BC)	587
567	MEREDITH MARSHALL	MACZE JDX ADX SPD SD GD	(ASSOC)	588
600				
602	KATE DALL	TJUKURPA TRAPPER AD JDX	(KOOLIE)	589
603	DR J M MAGAREY	FLYNN JDX ADX SPD SDX GD	(BC)	590
605	STEVE AND TERRI ROSE	KADNOOK GROUSES LEGEND ADM JDX	(LAB)	591
612	R L PADFIELD	JAZPA CD ADX JDX JDO ADO SPD	(ASSOC)	592
617	L K HAMMER AND K A EDWARDS	FENRIK MURPHYS OUTLAW ADM3 ADO3 JDM6 JFO4 SDM GDM SPDM	(GSP)	593
619	MICHAEL CHESWORTH	KAYLADENE TAKE IT EASY ADX JDX SPD	(BC)	594

Excellent Agility (E) - Ray Ashman

Sunday 10th March, 2013 (AM)

200				
201	TAMMY BEATTIE	MADDOGMADISON AD JDX	(ASSOC)	560
300				
301	VICKI JOSEPHS	SUMMASTORM JDX AD SDX SPDX GD CCD	(TERRIER)	561
400				
401	VICKI JOSEPHS	DEMON AD JD SPD SD RN	(POODLE (MIN))	562
500				
505	KATE DALL	TJUKURPA WILLOW AD JDM	(KOOLIE)	563
507	DR J M MAGAREY	GUIRMERE SCOUT GDSPDADSD	(BC)	564
508	LAURA DISTEFANO	ELLAGANT NEW VENTURE AD HT	(AUSSIE)	565
535	JESS HARMSWORTH	ZEE AD JDX GD	(ASSOC)	566
536	STEPHEN PEARSON	ICEANA MERCURY RISEN ET AD JD SPD	(VIZSLA)	567
544	J. LEWIS L. LLOYD	GWAERFEYN IVY AD JDX	(BC)	568
552	SARAH CROCKER	MACDONALD AD JDX SPD	(ASSOC)	569
555	LYNN MUSSETT	PORUSE DUALY BUILT CD JDX AD RN	(AUSSIE)	570
558	MR GARRY C HEINZE	BILLYDOGHEINZE AD JDX	(ASSOC)	571
564	LEIGH STRETTON	ASHA (JD)	(BC)	572
572	PAULINE GARDNER	DALLAS GARDNER AD JD	(ASSOC)	573
577	KATIE BUGEJA	BLACKDIAMONDTOPY AD JD	(ASSOC)	574
600				
602	KATE DALL	TJUKURPA TRAPPER AD JDX	(KOOLIE)	575
609	CAMILLA SLEETH	BLUEGRACE SEA CALLING AD JD	(PWD)	576

613	GARY STOCKMAN	KIWI MATAI JDX AD	(ASSOC)	577
-----	---------------	-------------------	---------	-----

Masters Agility (E) - Ray Ashman

Sunday 10th March, 2013 (AM)

300				
303	S. T. OBRIEN	HENDERCHIP KICKNUP DUST JDM JDO ADX	(POODLE (TOY))	595
305	SHARON MULSHINE	BINDI CD ADM ADO2 JDM JDO2 SD GD	(IGGY)	596
307	DAWN GLANVILLE	JENUIN NINA SIMONE CD RE ADM JDX SD	(POODLE (MIN))	597
309	MS MICHELE MOORE	TOONEYBANK STOPYA NAGGN ADX JDM SDX GD SPD	(SHELTIE)	598
400				
403	CAROLE DENEHEY	PHINEAS FOGG JDM ADM GD SDX SPDM JDO ADO TD FMX	(ASSOC)	599
407	VANESSA LOUGHLIN	GLENMAVE CHAIN REACTION ADM JDX	(NSDTR)	600
413	SUE GONELLI	LEAPIN LEXIE ADM JDM SPDX GD SD	(ASSOC)	601
415	MR SCOTT FLETCHER	JEOLENA BOY CANNY GO ADM ADO GDX JDM JDO SPDX SDX	(STAFFIE)	602
416	M A SCHNIDER	MONTULATA JADES GEM CCD ADX JDX SD GD SPD	(BC)	603
421	LUKE WILBY	ELSPAN BARKLY BLUE ADX JDX	(COCKER)	604
500				
502	STEPHEN PEARSON	FIDELS IN HOT PURSUIT ADX JDX	(BC)	605
511	JULIE LYON	ALBAJAIL EMBRACE THE RACE ADX JDX	(AUSSIE)	606
512	MR G MRS J MILNER	AG CH YEOVILLE ACCIDENTAL HERO ADM JDM ADO JDO GDM SDM SPDM CD HSAS	(BC)	607
513	G KISIELNICKI	AG CH GUIRMERE JAZZ ADM JDM ADO JDO SPD GDX SD	(BC)	608
514	STEVE AND TERRI ROSE	KADNOOK BLAZE OF GLORY ADX JD	(LAB)	609
518	K K KISIELNICKI	AG CH 500 KAYLADENE BORN TO RUN JDM ADM JDO ADO SPD	(BC)	610
519	VANESSA LOUGHLIN	MAGPIELANE SIGHING WIND CD ADM ADO3 JDM JDO4 GD SPD SD	(NSDTR)	611
525	JANINE FEIL	PADDINGTON CDX ADX JDX RN	(ASSOC)	612
526	RENEE PATTEN	T CH WILLIAM THEBLOODY CDX ET ADM JDM ADO JDO SDM GDX SPDX DWDFH HTMN RN	(ASSOC)	613
527	ANNE WARREN	KANEKY ROYAL EDITION ADM ADO GD SD JDX JDO SPD	(TERRIER (MAN))	614
532	HEATHER DONALDSON	RICKY DONALDSON ADX JDM	(ASSOC)	615
541	JULIE LYON ANA RICHARDSON	ELLAGANT ITS IN THE GENES ADX JDO JDM2 SPD GDX	(AUSSIE)	616
543	G KISIELNICKI	AG CH KAYLADENE CHOC ROYAL ADM JDM ADO JDO SPDM GDX SDG	(BC)	617
546	K K KISIELNICKI	AG CH KAYLADENE TRIPLE CHOC ADM JDM ADO JDO SPDM GDX SDX	(BC)	618

551	KERRIE L RYAN	BAILEY GIRL ADM JDM	(ASSOC)	619
554	R FAGAN	MACYS MYSTIC BLUE SAPPHIRE ADM JDM ADO JDO CD FM	(AUSSIE)	620
568	MEGAN SEMPLE	T CH ALANGLLEN JINDABYNE ROSE CCD ADM JDM SDX SPDX ET	(LAB)	621
569	JULIE LYON	SHEPALIAN DREAMS UNWIND ADM ADO JDM JDO GD SD SPD (IMP UK)	(AUSSIE)	622
575	SANDY STOCKMAN	JETI KNIGHT JDX ADX GD	(KELPIE)	623
576	MRS SL AND MR AC SANDERSON	ALANGLLEN ARWEN ROSE CD ADM ADO JDM JDO SD SPDX GDX	(LAB)	624
600				
601	KAROLYN DE GRAAUW	AG CH ZIGGY D ADM JDM ADO JDO GD PT SPMD DWDFS	(ASSOC)	625
603	DR J M MAGAREY	FLYNN JDX ADX SPD SDX GD	(BC)	626
607	L K HAMMER AND K A EDWARDS	FENIK LIQUORICE ALSPORT ADM2 ADO JDM JDO SDX GDX SPDM	(GSP)	627
611	MRS JENNY WILLIAMS	ROBBIE JAY ADX ADO JDO JDM	(ASSOC)	628
612	R L PADFIELD	JAZPA CD ADX JDX JDO ADO SPD	(ASSOC)	629
617	L K HAMMER AND K A EDWARDS	FENRIK MURPHYS OUTLAW ADM3 ADO3 JDM6 JFO4 SDM GDM SPDM	(GSP)	630
619	MICHAEL CHESWORTH	KAYLADENE TAKE IT EASY ADX JDX SPD	(BC)	631
622	MIKA PEACE	DYKINTA RED ALERT ADM JDM ADO JDO GDX SD SPD	(AUSSIE)	632
625	L K HAMMER AND K A EDWARDS	PACE VON DER MADLAGE (IMP DEU) ADX ADO JDX SD GD SPDX	(GSP)	633

Open Jumping (E) - Murray Tyler

Sunday 10th March, 2013 (AM)

400				
408	SHARON MULSHINE	LUCY ADM ADO5 JDX JDO3 SD SPD	(IGGY)	651
411	TINA CHESWORTH	ALCLUTHA KILTS A FLYIN ADM JDX GD SPDX ADO SD	(SHELTIE)	652
412	MRS H M EAVES	RICOCHERZ DYFRI LILI RHOSLYN TDX	(WELSHIE)	653
500				
515	J. LEWIS L. LLOYD	NOONBARRA ATILLA ADM JDM ADO JDO GDX SPDX HIT	(KELPIE)	654
525	JANINE FEIL	PADDINGTON CDX ADX JDX RN	(ASSOC)	655
527	ANNE WARREN	KANEKY ROYAL EDITION ADM ADO GD SD JDX JDO SPD	(TERRIER (MAN))	656
541	JULIE LYON ANA RICHARDSON	ELLAGANT ITS IN THE GENES ADX JDO JDM2 SPD GDX	(AUSSIE)	657
552	SARAH CROCKER	MACDONALD AD JDX SPD	(ASSOC)	658
558	MR GARRY C HEINZE	BILLYDOGHEINZE AD JDX	(ASSOC)	659
564	LEIGH STRETTON	ASHA (JD)	(BC)	660

567	MEREDITH MARSHALL	MACZE JDX ADX SPD SD GD	(ASSOC)	661
574	SARAH MCDOWELL	ZAC JD	(BC)	662
575	SANDY STOCKMAN	JETI KNIGHT JDX ADX GD	(KELPIE)	663
576	MRS SL AND MR AC SANDERSON	ALANGLLEN ARWEN ROSE CD ADM ADO JDM JDO SD SPDX GDX	(LAB)	664
600				
603	DR J M MAGAREY	FLYNN JDX ADX SPD SDX GD	(BC)	665
606	J. LEWIS L. LLOYD	NOONBARRA CRUZ AD JDX	(KELPIE)	666
612	R L PADFIELD	JAZPA CD ADX JDX JDO ADO SPD	(ASSOC)	667
613	GARY STOCKMAN	KIWI MATAI JDX AD	(ASSOC)	668
625	L K HAMMER AND K A EDWARDS	PACE VON DER MADLAGE (IMP DEU) ADX ADO JDX SD GD SPDX	(GSP)	669

Excellent Jumping (E) - Murray Tyler

Sunday 10th March, 2013 (AM)

400				
401	VICKI JOSEPHS	DEMON AD JD SPD SD RN	(POODLE (MIN))	670
409	MRS K MR G TAYLOR	SILVANWOOD HELLS BELLS RN JD	(AUSSIE)	671
500				
503	REBEKAH FOORD	ELLAGANT HIDE AND SEEK CCDJD	(AUSSIE)	672
514	STEVE AND TERRI ROSE	KADNOOK BLAZE OF GLORY ADX JD	(LAB)	673
524	MRS K MR G TAYLOR	NGALLA ONE OF THESE NIGHTS RN AD JD	(AUSSIE)	674
536	STEPHEN PEARSON	ICEANA MERCURY RISEN ET AD JD SPD	(VIZSLA)	675
549	KATE SCOTT	BELADELE XTREME XCESS JD	(BC)	676
553	MRS EMI HINAGO MR DEAN CROSSTHWAITE	GUIRMERE BLUEMOON NIAH JD AD	(BC)	677
557	MRS EMI HINAGO MR DEAN CROSSTHWAITE	SEAMIST KIARA JD	(BC)	678
564	LEIGH STRETTON	ASHA (JD)	(BC)	679
572	PAULINE GARDNER	DALLAS GARDNER AD JD	(ASSOC)	680
574	SARAH MCDOWELL	ZAC JD	(BC)	681
577	KATIE BUGEJA	BLACKDIAMONDTOPY AD JD	(ASSOC)	682
600				
604	FIONA COLENZO	ABBIESTAR SPECIALIZED JD	(VIZSLA)	683
609	CAMILLA SLEETH	BLUEGRACE SEA CALLING AD JD	(PWD)	684
616	FIONA COLENZO	CH ABBIESTAR MADE TO ORDER JD	(VIZSLA)	685

200				
201	TAMMY BEATTIE	MADDOGMADISON AD JDX	(ASSOC)	686
300				
301	VICKI JOSEPHS	SUMMASTORM JDX AD SDX SPDX GD CCD	(TERRIER)	687
302	CAROLE DENEHEY	HENDERCHIP DARTAGNAN JDX FD	(POODLE (TOY))	688
303	S. T. OBRIEN	HENDERCHIP KICKNUP DUST JDM JDO ADX	(POODLE (TOY))	689
304	MR E. R. FLETCHER	DEGUMLY NIKITA ROSE ADX JDX	(POODLE (MIN))	690
305	SHARON MULSHINE	BINDI CD ADM ADO2 JDM JDO2 SD GD	(IGGY)	691
307	DAWN GLANVILLE	JENUIN NINA SIMONE CD RE ADM JDX SD	(POODLE (MIN))	692
309	MS MICHELE MOORE	TOONEYBANK STOPYA NAGGN ADX JDM SDX GD SPD	(SHELTIE)	693
312	MR E. R. FLETCHER	DEGUMLY SWEET MUSIC ADX JDX	(POODLE (MIN))	694
400				
405	S. T. OBRIEN	DEBONAIR DARCY ADM ADO JDM JDO SPDM GD	(ASSOC)	695
406	MR E. R. FLETCHER	DEGUMLY CRICLIAM ADX JDX	(POODLE (MIN))	696
407	VANESSA LOUGHLIN	GLENMAVE CHAIN REACTION ADM JDX	(NSDTR)	697
415	MR SCOTT FLETCHER	JEOLENA BOY CANNY GO ADM ADO GDX JDM JDO SPDX SDX	(STAFFIE)	698
416	M A SCHNIDER	MONTULATA JADES GEM CCD ADX JDX SD GD SPD	(BC)	699
421	LUKE WILBY	ELSPAN BARKLY BLUE ADX JDX	(COCKER)	700
500				
501	JESS HARMSWORTH	DARCY DIVA CDX ADM JDM ADO JDO GDX SD	(ASSOC)	701
504	KAROLYN DE GRAAUW	PHOEBE ADX JDM	(KELPIE)	702
505	KATE DALL	TJUKURPA WILLOW AD JDM	(KOOLIE)	703
506	PATRICIA ATTARD PAUL WARD	HOLLY GOLIGHTLY ADM JDM JDO ADO SPMD	(ASSOC)	704
511	JULIE LYON	ALBAJAIL EMBRACE THE RACE ADX JDX	(AUSSIE)	705
512	MR G MRS J MILNER	AG CH YEOVILLE ACCIDENTAL HERO ADM JDM ADO JDO GDM SDM SPDM CD HSAS	(BC)	706
513	G KISIELNICKI	AG CH GUIRMERE JAZZ ADM JDM ADO JDO SPD GDX SD	(BC)	707
518	K K KISIELNICKI	AG CH 500 KAYLADENE BORN TO RUN JDM ADM JDO ADO SPD	(BC)	708
519	VANESSA LOUGHLIN	MAGPIELANE SIGHING WIND CD ADM ADO3 JDM JDO4 GD SPD SD	(NSDTR)	709
525	JANINE FEIL	PADDINGTON CDX ADX JDX RN	(ASSOC)	710

526	RENEE PATTEN	T CH WILLIAM THEBLOODY CDX ET ADM JDM ADO JDO SDM GDX SPDX DWDF A HTMN RN	(ASSOC)	711
527	ANNE WARREN	KANEKY ROYAL EDITION ADM ADO GD SD JDX JDO SPD	(TERRIER (MAN))	712
532	HEATHER DONALDSON	RICKY DONALDSON ADX JDM	(ASSOC)	713
537	REBEKAH FOORD	MACYS MINIATURE PATCHES CDADO7ADM4JDM6JDO5GDSPXFDM	(AUSSIE)	714
538	PATRICIA ATTARD PAUL WARD	SCOUTS HONOUR AD JDM	(ASSOC)	715
541	JULIE LYON ANA RICHARDSON	ELLAGANT ITS IN THE GENES ADX JDO JDM2 SPD GDX	(AUSSIE)	716
542	MR G MRS J MILNER	GUIRMERE RUM RUNNER JDX HT	(BC)	717
543	G KISIELNICKI	AG CH KAYLADENE CHOC ROYAL ADM JDM ADO JDO SPDM GDX SDG	(BC)	718
544	J. LEWIS L. LLOYD	GWAERFEYN IVY AD JDX	(BC)	719
546	K K KISIELNICKI	AG CH KAYLADENE TRIPLE CHOC ADM JDM ADO JDO SPDM GDX SDX	(BC)	720
551	KERRIE L RYAN	BAILEY GIRL ADM JDM	(ASSOC)	721
552	SARAH CROCKER	MACDONALD AD JDX SPD	(ASSOC)	722
554	R FAGAN	MACYS MYSC BLUE SAPPHIRE ADM JDM ADO JDO CD FM	(AUSSIE)	723
556	MS TRICIA DUNLOP	SASSYBRAT JDX AD	(BC)	724
567	MEREDITH MARSHALL	MACZE JDX ADX SPD SD GD	(ASSOC)	725
568	MEGAN SEMPLE	T CH ALANGLN JINDABYNE ROSE CCD ADM JDM SDX SPDX ET	(LAB)	726
569	JULIE LYON	SHEPALIAN DREAMS UNWIND ADM ADO JDM JDO GD SD SPD (IMP UK)	(AUSSIE)	727
575	SANDY STOCKMAN	JETI KNIGHT JDX ADX GD	(KELPIE)	728
576	MRS SL AND MR AC SANDERSON	ALANGLN ARWEN ROSE CD ADM ADO JDM JDO SD SPDX GDX	(LAB)	729
600				
603	DR J M MAGAREY	FLYNN JDX ADX SPD SDX GD	(BC)	730
611	MRS JENNY WILLIAMS	ROBBIE JAY ADX ADO JDO JDM	(ASSOC)	731
612	R L PADFIELD	JAZPA CD ADX JDX JDO ADO SPD	(ASSOC)	732
613	GARY STOCKMAN	KIWI MATAI JDX AD	(ASSOC)	733
619	MICHAEL CHESWORTH	KAYLADENE TAKE IT EASY ADX JDX SPD	(BC)	734
622	MIKA PEACE	DYKINTA RED ALERT ADM JDM ADO JDO GDX SD SPD	(AUSSIE)	735

Novice Jumping (E) - Murray Tyler

Sunday 10th March, 2013 (AM)

300				
311	VICKI JOSEPHS	GLORI	(TERRIER)	634
313	TINA CHESWORTH	YACKAWIL YESTERDAYS DREAM	(SHELTIE)	635

400

412	MRS H M EAVES	RICOCHÉZ DYFRI LILI RHOSLYN TDX	(WELSHIE)	636
500				
507	DR J M MAGAREY	GUIRMERE SCOUT GDSPDADSD	(BC)	637
509	MS KIERSTEN COULTER	COMEBY MORE THAN ME	(AUSSIE)	638
521	SUSAN KERWIN	MATAGANAH SAPPHIRE MOON	(LAB)	639
528	VIVIAN O GRADY	MATILDAOGRADY	(ASSOC)	640
529	MRS ROSALINE TWAITES DR R ATYEO	YEOVILLE MISS INDEPENDENT HT	(BC)	641
548	MRS K MR G TAYLOR	AUSSIE MIA RN	(ASSOC)	642
559	G KISIELNICKI	KAYLADENE ROXYZ LIL ROCKET	(BC)	643
563	SARAH GREENSTREET	AMAZINGGRACIE	(ASSOC)	644
565	ELAINE RAWILLER	COOPERRAWILLER	(ASSOC)	645
566	MRS M J CORRY-THOMAS	SHANOWL QUIZA WHIZZ SPICE	(BC)	646
573	K K KISIELNICKI	KAYLADENE IGNITE MY FIRE	(BC)	647
600				
614	MS D M JAMES D L RAE	CH ARANYBAJNOK HUNT MASTER ET	(VIZSLA)	648
615	SUSAN KERWIN	ALANGLÉN KEEP THE FAITH CDX ET	(LAB)	649
618	PETER MARMO	ROZATE THE SEA HAWK	(AUSSIE)	650

Masters Jumping (F) - Adrian Tilley

Sunday 10th March, 2013 (AM)

600				
625	L K HAMMER AND K A EDWARDS	PACE VON DER MADLAGE (IMP DEU) ADX ADO JDX SD GD SPDX	(GSP)	736
622	MIKA PEACE	DYKINTA RED ALERT ADM JDM ADO JDO GDX SD SPD	(AUSSIE)	737
619	MICHAEL CHESWORTH	KAYLADENE TAKE IT EASY ADX JDX SPD	(BC)	738
617	L K HAMMER AND K A EDWARDS	FENRIK MURPHYS OUTLAW ADM3 ADO3 JDM6 JFO4 SDM GDM SPDM	(GSP)	739
613	GARY STOCKMAN	KIWI MATAI JDX AD	(ASSOC)	740
611	MRS JENNY WILLIAMS	ROBBIE JAY ADX ADO JDO JDM	(ASSOC)	741
607	L K HAMMER AND K A EDWARDS	FENIK LIQUORICE ALSPORT ADM2 ADO JDM JDO SDX GDX SPDM	(GSP)	742
605	STEVE AND TERRI ROSE	KADNOOK GROUSES LEGEND ADM JDX	(LAB)	743
603	DR J M MAGAREY	FLYNN JDX ADX SPD SDX GD	(BC)	744
601	KAROLYN DE GRAAUW	AG CH ZIGGY D ADM JDM ADO JDO GD PT SPMD DWDFS	(ASSOC)	745
500				
576	MRS SL AND MR AC SANDERSON	ALANGLÉN ARWEN ROSE CD ADM ADO JDM JDO SD SPDX GDX	(LAB)	746
575	SANDY STOCKMAN	JETI KNIGHT JDX ADX GD	(KELPIE)	747
571	BELINDA TEBBET	DARGO TEBBET AD JDX SD ET	(ASSOC)	748

569	JULIE LYON	SHEPALIAN DREAMS UNWIND ADM ADO JDM JDO GD SD SPD (IMP UK)	(AUSSIE)	749
568	MEGAN SEMPLE	T CH ALANGLN JINDABYNE ROSE CCD ADM JDM SDX SPD ET	(LAB)	750
558	MR GARRY C HEINZE	BILLYDOGHEINZE AD JDX	(ASSOC)	751
556	MS TRICIA DUNLOP	SASSYBRAT JDX AD	(BC)	752
555	LYNN MUSSETT	PORUSE DUALY BUILT CD JDX AD RN	(AUSSIE)	753
554	R FAGAN	MACYS MYSC BLUE SAPPHIRE ADM JDM ADO JDO CD FM	(AUSSIE)	754
552	SARAH CROCKER	MACDONALD AD JDX SPD	(ASSOC)	755
551	KERRIE L RYAN	BAILEY GIRL ADM JDM	(ASSOC)	756
546	K K KISIELNICKI	AG CH KAYLADENE TRIPLE CHOC ADM JDM ADO JDO SPDM GDX SDX	(BC)	757
544	J. LEWIS L. LLOYD	GWAERFEYN IVY AD JDX	(BC)	758
543	G KISIELNICKI	AG CH KAYLADENE CHOC ROYAL ADM JDM ADO JDO SPDM GDX SDG	(BC)	759
542	MR G MRS J MILNER	GUIRMERE RUM RUNNER JDX HT	(BC)	760
541	JULIE LYON ANA RICHARDSON	ELLAGANT ITS IN THE GENES ADX JDO JDM2 SPD GDX	(AUSSIE)	761
538	PATRICIA ATTARD PAUL WARD	SCOUTS HONOUR AD JDM	(ASSOC)	762
537	REBEKAH FOORD	MACYS MINIATURE PATCHES CDADO7ADM4JDM6JDO5GDXSPXFD	(AUSSIE)	763
535	JESS HARMSWORTH	ZEE AD JDX GD	(ASSOC)	764
526	RENEE PATTEN	T CH WILLIAM THEBLOODY CDX ET ADM JDM ADO JDO SDM GDX SPD DWDF HTMN RN	(ASSOC)	765
525	JANINE FEIL	PADDINGTON CDX ADX JDX RN	(ASSOC)	766
519	VANESSA LOUGHLIN	MAGPIELANE SIGHING WIND CD ADM ADO3 JDM JDO4 GD SPD SD	(NSDTR)	767
518	K K KISIELNICKI	AG CH 500 KAYLADENE BORN TO RUN JDM ADM JDO ADO SPD	(BC)	768
513	G KISIELNICKI	AG CH GUIRMERE JAZZ ADM JDM ADO JDO SPD GDX SD	(BC)	769
512	MR G MRS J MILNER	AG CH YEOVILLE ACCIDENTAL HERO ADM JDM ADO JDO GDM SDM SPDM CD HSAS	(BC)	770
511	JULIE LYON	ALBAJAIL EMBRACE THE RACE ADX JDX	(AUSSIE)	771
506	PATRICIA ATTARD PAUL WARD	HOLLY GOLIGHTLY ADM JDM JDO ADO SPMD	(ASSOC)	772
505	KATE DALL	TJUKURPA WILLOW AD JDM	(KOOLIE)	773
504	KAROLYN DE GRAAUW	PHOEBE ADX JDM	(KELPIE)	774
502	STEPHEN PEARSON	FIDELS IN HOT PURSUIT ADX JDX	(BC)	775
501	JESS HARMSWORTH	DARCY DIVA CDX ADM JDM ADO JDO GDX SD	(ASSOC)	776
400				
417	BEL ADELE KENNELS / ANGIE GUNTHER	BEL ADELE XTREME XTACY CCD JDX	(BC)	777
416	M A SCHNIDER	MONTULATA JADES GEM CCD ADX JDX SD GD SPD	(BC)	778
415	MR SCOTT FLETCHER	JEOLENA BOY CANNY GO ADM ADO GDX JDM JDO SPDX SDX	(STAFFIE)	779

413	SUE GONELLI	LEAPIN LEXIE ADM JDM SPDX GD SD	(ASSOC)	780
407	VANESSA LOUGHLIN	GLENMAVE CHAIN REACTION ADM JDX	(NSDTR)	781
405	S. T. OBRIEN	DEBONAIR DARCY ADM ADO JDM JDO SPDM GD	(ASSOC)	782
404	LAURA DISTEFANO	AG CH 400 NELLIE GIRL ADM ADO JDM JDO HT PT GD	(ASSOC)	783
402	BEL ADELE KENNELS / ANGIE GUNTHER	BEL ADELE UR UNIQUE. CDX AD JDX	(BC)	784
300				
309	MS MICHELE MOORE	TOONEYBANK STOPYA NAGGN ADX JDM SDX GD SPD	(SHELTIE)	785
305	SHARON MULSHINE	BINDI CD ADM ADO2 JDM JDO2 SD GD	(IGGY)	786
303	S. T. OBRIEN	HENDERCHIP KICKNUP DUST JDM JDO ADX	(POODLE (TOY))	787
200				
201	TAMMY BEATTIE	MADDOGMADISON AD JDX	(ASSOC)	788

Excellent Jumping (F) - Adrian Tilley

Sunday 10th March, 2013 (AM)

600				
616	FIONA COLENZO	CH ABBIESTAR MADE TO ORDER JD	(VIZSLA)	789
609	CAMILLA SLEETH	BLUEGRACE SEA CALLING AD JD	(PWD)	790
608	MRS K MR G TAYLOR	AUSSIE BUNDY CCD RN JD	(ASSOC)	791
604	FIONA COLENZO	ABBIESTAR SPECIALIZED JD	(VIZSLA)	792
500				
577	KATIE BUGEJA	BLACKDIAMONDTOPY AD JD	(ASSOC)	793
574	SARAH MCDOWELL	ZAC JD	(BC)	794
572	PAULINE GARDNER	DALLAS GARDNER AD JD	(ASSOC)	795
564	LEIGH STRETTON	ASHA (JD)	(BC)	796
557	MRS EMI HINAGO MR DEAN CROSTHWAITE	SEAMIST KIARA JD	(BC)	797
553	MRS EMI HINAGO MR DEAN CROSTHWAITE	GUIRMERE BLUEMOON NIAH JD AD	(BC)	798
549	KATE SCOTT	BELADELE XTREME XCESS JD	(BC)	799
524	MRS K MR G TAYLOR	NGALLA ONE OF THESE NIGHTS RN AD JD	(AUSSIE)	800
514	STEVE AND TERRI ROSE	KADNOOK BLAZE OF GLORY ADX JD	(LAB)	801

Open Jumping (F) - Adrian Tilley**Sunday 10th March, 2013 (AM)**

600				
625	L K HAMMER AND K A EDWARDS	PACE VON DER MADLAGE (IMP DEU) ADX ADO JDX SD GD SPDX	(GSP)	802
613	GARY STOCKMAN	KIWI MATAI JDX AD	(ASSOC)	803
609	CAMILLA SLEETH	BLUEGRACE SEA CALLING AD JD	(PWD)	804
605	STEVE AND TERRI ROSE	KADNOOK GROUSES LEGEND ADM JDX	(LAB)	805
603	DR J M MAGAREY	FLYNN JDX ADX SPD SDX GD	(BC)	806
602	KATE DALL	TJUKURPA TRAPPER AD JDX	(KOOLIE)	807
500				
575	SANDY STOCKMAN	JETI KNIGHT JDX ADX GD	(KELPIE)	808
574	SARAH MCDOWELL	ZAC JD	(BC)	809
564	LEIGH STRETTON	ASHA (JD)	(BC)	810
557	MRS EMI HINAGO MR DEAN CROSTHWAITE	SEAMIST KIARA JD	(BC)	811
556	MS TRICIA DUNLOP	SASSYBRAT JDX AD	(BC)	812
553	MRS EMI HINAGO MR DEAN CROSTHWAITE	GUIRMERE BLUEMOON NIAH JD AD	(BC)	813
552	SARAH CROCKER	MACDONALD AD JDX SPD	(ASSOC)	814
532	HEATHER DONALDSON	RICKY DONALDSON ADX JDM	(ASSOC)	815
525	JANINE FEIL	PADDINGTON CDX ADX JDX RN	(ASSOC)	816
512	MR G MRS J MILNER	AG CH YEOVILLE ACCIDENTAL HERO ADM JDM ADO JDO GDM SDM SPDM CD HSAS	(BC)	817
400				
412	MRS H M EAVES	RICOCHERZ DYFRI LILI RHOSLYN TDX	(WELSHIE)	818
411	TINA CHESWORTH	ALCLUTHA KILTS A FLYIN ADM JDX GD SPDX ADO SD	(SHELTIE)	819
408	SHARON MULSHINE	LUCY ADM ADO5 JDX JDO3 SD SPD	(IGGY)	820

Novice Jumping (F) - Adrian Tilley**Sunday 10th March, 2013 (AM)**

600				
618	PETER MARMO	ROZATE THE SEA HAWK	(AUSSIE)	821
615	SUSAN KERWIN	ALANGLLEN KEEP THE FAITH CDX ET	(LAB)	822
500				
573	K K KISIELNICKI	KAYLADENE IGNITE MY FIRE	(BC)	823
565	ELAINE RAWILLER	COOPERRAWILLER	(ASSOC)	824
563	SARAH GREENSTREET	AMAZINGGRACIE	(ASSOC)	825
559	G KISIELNICKI	KAYLADENE ROXYZ LIL ROCKET	(BC)	826
529	MRS ROSALINE TWAITES DR R ATYEO	YEOVILLE MISS INDEPENDENT HT	(BC)	827

528	VIVIAN O GRADY	MATILDAOGRADY	(ASSOC)	828
509	MS KIERSTEN COULTER	COMEYB MORE THAN ME	(AUSSIE)	829
507	DR J M MAGAREY	GUIRMERE SCOUT GDSPDADSD	(BC)	830
400				
414	SALLY BURGESS	OLIVERJAMES RN	(ASSOC)	831
412	MRS H M EAVES	RICOCHÉZ DYFRI LILI RHOSLYN TDX	(WELSHIE)	832
300				
311	VICKI JOSEPHS	GLORI	(TERRIER)	833



SUNDAY PM

Open - Mr Ray Ashman Sunday 10th March, 2013 (PM)

O401	ANNE MANN	KOMBINALONG SUPER SAPPHIRA CD RN	ASSOCIATE	B	430
O402	CHRIS WITTICK	GRAND CH HANAFOR BARETT BAILEY CD	HUNGARIAN VIZSLA	D	600
O403	LIZ SHARP	GRAEBROOK NO PEEKING CD	HUNGARIAN VIZSLA	B	540
O404	DAWN GLANVILLE	JENUIN NINA SIMONE CD RE ADM JDX SD	POODLE (MINIATURE)	B	350
O405	REBECCA MCGROARTY	HEVNSENT SWEET BABYBLU CDX	AUSTRALIAN SHEPHERD	B	500

CDX	1 ST	SCORE
CDX	2 ND	SCORE
CDX	3 RD	SCORE

Novice - Mr Ray Ashman Sunday 10th March, 2013 (PM)

O406	MRS P SCOTT	CH FLYNTAHN MERCEDES	GERMAN SHORTHAIRED POINTER	B
O407	MS KIERSTEN COULTER	NGALLA WISH UPON A STAR	AUSTRALIAN SHEPHERD	B

CD	1 ST	SCORE
CD	2 ND	SCORE
CD	3 RD	SCORE

Community Companion Dog - Mr Ray Ashman Sunday 10th March, 2013 (PM)

O408	I. IRWIN	RASTI	ASSOCIATE	D
O409	KAREN KELLY HOURTICOLON	BRANDYMUZZA	ASSOCIATE	B
O410	KATHRYN HOLE	LYNSLINE BLUE JASPER	SHETLAND SHEEPDOG	D
O411	MR ROSS CARLSON	CH ELLAGANT TOP GUN RN	AUSTRALIAN SHEPHERD	D
O412	LISA MAREE FRY	ERNIE	ASSOCIATE	D
O413	MR GRAHAM A . WILKINSON	SEAMUS WILKINSON	ASSOCIATE	D
O414	MS D M JAMES D L RAE	CH ARANYBAJNOK HUNT MASTER ET	HUNGARIAN VIZSLA	D
O415	CASSANDRA COLBERT	IRISHCLAN TOTAL ECLIPSE	COCKER SPANIEL	S
O416	MR GARRY C HEINZE	BILLYDOGHEINZE AD JDX	ASSOCIATE	B

CCD	1 ST	SCORE
CCD	2 ND	SCORE
CCD	3 RD	SCORE

Utility - Mr Dave Rumble Sunday 10th March, 2013 (PM)

O417	ANDREW MACDONALD	STEVIEJOSH TEUTONIC KNIGHT CDX TD ET	GERMAN SHEPHERD DOG	D	650
O418	ANNE MANN	ZOE UD RE TD ET NOONBARRA BOB II UD ADM ADO JDM	ASSOCIATE	B	470
O419	HJ RK DIAMOND	SPD	AUSTRALIAN KELPIE	D	500
O420	LIZ SHARP	HUBERTUS IRESISTIBLE ISH CDX	HUNGARIAN VIZSLA	B	610
O421	RON SCIBERRAS	SPRITZEE INFLIGHT CDX	SCHNAUZER (MIN.)	D	350
O422	ADRIAN AND RANA BROGAN	JAMARANG BISKIT BROGAN CDX ET RA TCH AUSSIELAB MIDSUMMERDREAM CDX	GOLDEN RETRIEVER	D	600
O423	ASHAMBER KENNELS	JD RE	LABRADOR RETRIEVER	B	530

UD	1 ST	SCORE
UD	2 ND	SCORE
UD	3 RD	SCORE

Masters Agility (G) - Murray Tyler

Sunday 10th March, 2013 (PM)

300					
303	S. T. OBRIEN	HENDERCHIP KICKNUP DUST JDM JDO ADX	(POODLE (TOY))		834
305	SHARON MULSHINE	BINDI CD ADM ADO2 JDM JDO2 SD GD	(IGGY)		835
307	DAWN GLANVILLE	JENUIN NINA SIMONE CD RE ADM JDX SD	(POODLE (MIN))		836
309	MS MICHELE MOORE	TOONEYBANK STOPYA NAGGN ADX JDM SDX GD SPD	(SHELTIE)		837
400					
403	CAROLE DENEHEY	PHINEAS FOGG JDM ADM GD SDX SPDM JDO ADO TD FMX	(ASSOC)		838
406	MR E. R. FLETCHER	DEGUMLY CRICLIAM ADX JDX	(POODLE (MIN))		839
407	VANESSA LOUGHLIN	GLENMAVE CHAIN REACTION ADM JDX	(NSDTR)		840
408	SHARON MULSHINE	LUCY ADM ADO5 JDX JDO3 SD SPD	(IGGY)		841
411	TINA CHESWORTH	ALCLUTHA KILTS A FLYIN ADM JDX GD SPDX ADO SD	(SHELTIE)		842
413	SUE GONELLI	LEAPIN LEXIE ADM JDM SPDX GD SD	(ASSOC)		843
415	MR SCOTT FLETCHER	JEOLENA BOY CANNY GO ADM ADO GDX JDM JDO SPDX SDX	(STAFFIE)		844
416	M A SCHNIDER	MONTULATA JADES GEM CCD ADX JDX SD GD SPD	(BC)		845
418	HJ RK DIAMOND	HOLLYBRIT SHARP ASA TACK ADM JDM6 SPDX GD	(POODLE (MIN))		846
421	LUKE WILBY	ELSPAN BARKLY BLUE ADX JDX	(COCKER)		847

500				
511	JULIE LYON	ALBAJAIL EMBRACE THE RACE ADX JDX	(AUSSIE)	848
512	MR G MRS J MILNER	AG CH YEOVILLE ACCIDENTAL HERO ADM JDM ADO JDO GDM SDM SPDM CD HSAS	(BC)	849
513	G KISIELNICKI	AG CH GUIRMERE JAZZ ADM JDM ADO JDO SPD GDX SD	(BC)	850
514	STEVE AND TERRI ROSE	KADNOOK BLAZE OF GLORY ADX JD	(LAB)	851
518	K K KISIELNICKI	AG CH 500 KAYLADENE BORN TO RUN JDM ADM JDO ADO SPD	(BC)	852
519	VANESSA LOUGHLIN	MAGPIELANE SIGHING WIND CD ADM ADO3 JDM JDO4 GD SPD SD	(NSDTR)	853
525	JANINE FEIL	PADDINGTON CDX ADX JDX RN	(ASSOC)	854
526	RENEE PATTEN	T CH WILLIAM THEBLOODY CDX ET ADM JDM ADO JDO SDM GDX SPDX DWDFM HTMN RN	(ASSOC)	855
527	ANNE WARREN	KANEKY ROYAL EDITION ADM ADO GD SD JDX JDO SPD	(TERRIER (MAN))	856
532	HEATHER DONALDSON	RICKY DONALDSON ADX JDM	(ASSOC)	857
541	JULIE LYON ANA RICHARDSON	ELLAGANT ITS IN THE GENES ADX JDO JDM2 SPD GDX	(AUSSIE)	858
543	G KISIELNICKI	AG CH KAYLADENE CHOC ROYAL ADM JDM ADO JDO SPDM GDX SDG	(BC)	859
546	K K KISIELNICKI	AG CH KAYLADENE TRIPLE CHOC ADM JDM ADO JDO SPDM GDX SDX	(BC)	860
551	KERRIE L RYAN	BAILEY GIRL ADM JDM	(ASSOC)	861
554	R FAGAN	MACYS MYSTIC BLUE SAPPHIRE ADM JDM ADO JDO CD FM	(AUSSIE)	862
561	K K KISIELNICKI	HILLCREST JUMPIN JIVE (IMP USA) JDM ADM	(BC)	863
567	MEREDITH MARSHALL	MACZE JDX ADX SPD SD GD	(ASSOC)	864
568	MEGAN SEMPLE	T CH ALANGLN JINDABYNE ROSE CCD ADM JDM SDX SPDX ET	(LAB)	865
569	JULIE LYON	SHEP ALIAN DREAMS UNWIND ADM ADO JDM JDO GD SD SPD (IMP UK)	(AUSSIE)	866
575	SANDY STOCKMAN	JETI KNIGHT JDX ADX GD	(KELPIE)	867
576	MRS SL AND MR AC SANDERSON	ALANGLN ARWEN ROSE CD ADM ADO JDM JDO SD SPDX GDX	(LAB)	868
600				
601	KAROLYN DE GRAAUW	AG CH ZIGGY D ADM JDM ADO JDO GD PT SPMD DWDFS	(ASSOC)	869
603	DR J M MAGAREY	FLYNN JDX ADX SPD SDX GD	(BC)	870
605	STEVE AND TERRI ROSE	KADNOOK GROUSES LEGEND ADM JDX	(LAB)	871
607	L K HAMMER AND K A EDWARDS	FENIK LIQUORICE ALSPORT ADM2 ADO JDM JDO SDX GDX SPDM	(GSP)	872
611	MRS JENNY WILLIAMS	ROBBIE JAY ADX ADO JDO JDM	(ASSOC)	873
612	R L PADFIELD	JAZPA CD ADX JDX JDO ADO SPD	(ASSOC)	874

617	L K HAMMER AND K A EDWARDS	FENRIK MURPHYS OUTLAW ADM3 ADO3 JDM6 JFO4 SDM GDM SPDM	(GSP)	875
619	MICHAEL CHESWORTH	KAYLADENE TAKE IT EASY ADX JDX SPD	(BC)	876
622	MIKA PEACE	DYKINTA RED ALERT ADM JDM ADO JDO GDX SD SPD	(AUSSIE)	877
625	L K HAMMER AND K A EDWARDS	PACE VON DER MADLAGE (IMP DEU) ADX ADO JDX SD GD SPDX	(GSP)	878

Excellent Agility (G) - Murray Tyler

Sunday 10th March, 2013 (PM)

200				
201	TAMMY BEATTIE	MADDOGMADISON AD JDX	(ASSOC)	879
202	KYLEY CONDER	CHEZJOLIE FANCY STUFF CCD JDX AD RN	(POODLE (TOY))	880
300				
301	VICKI JOSEPHS	SUMMASTORM JDX AD SDX SPDX GD CCD	(TERRIER)	881
304	MR E. R. FLETCHER	DEGUMLY NIKITA ROSE ADX JDX	(POODLE (MIN))	882
312	MR E. R. FLETCHER	DEGUMLY SWEET MUSIC ADX JDX	(POODLE (MIN))	883
400				
401	VICKI JOSEPHS	DEMON AD JD SPD SD RN	(POODLE (MIN))	884
500				
505	KATE DALL	TJUKURPA WILLOW AD JDM	(KOOLIE)	885
507	DR J M MAGAREY	GUIRMERE SCOUT GDSPDADSD	(BC)	886
522	LINDENBRAE KENNELS	LINDENBRAE TARFIN FEY CONJURER CCD RN JD AD	(BC)	887
536	STEPHEN PEARSON	ICEANA MERCURY RISEN ET AD JD SPD	(VIZSLA)	888
544	J. LEWIS L. LLOYD	GWAERFEYN IVY AD JDX	(BC)	889
552	SARAH CROCKER	MACDONALD AD JDX SPD	(ASSOC)	890
555	LYNN MUSSETT	PORUSE DUALY BUILT CD JDX AD RN	(AUSSIE)	891
558	MR GARRY C HEINZE	BILLYDOGHEINZE AD JDX	(ASSOC)	892
564	LEIGH STRETTON	ASHA (JD)	(BC)	893
572	PAULINE GARDNER	DALLAS GARDNER AD JD	(ASSOC)	894
577	KATIE BUGEJA	BLACKDIAMONDTOPY AD JD	(ASSOC)	895
600				
602	KATE DALL	TJUKURPA TRAPPER AD JDX	(KOOLIE)	896
613	GARY STOCKMAN	KIWI MATAI JDX AD	(ASSOC)	897

Novice Agility (G) - Murray Tyler**Sunday 10th March, 2013 (PM)**

400				
409	MRS K MR G TAYLOR	SILVANWOOD HELLS BELLS RN JD	(AUSSIE)	898
412	MRS H M EAVES	RICOCHAZ DYFRI LILI RHOSLYN TDX	(WELSHIE)	899
414	SALLY BURGESS	OLIVERJAMES RN	(ASSOC)	900
500				
509	MS KIERSTEN COULTER	COMEBY MORE THAN ME	(AUSSIE)	901
529	MRS ROSALINE TWAITES DR R ATYEO	YEOVILLE MISS INDEPENDENT HT	(BC)	902
549	KATE SCOTT	BELADELE XTREME XCESS JD	(BC)	903
559	G KISIELNICKI	KAYLADENE ROXYZ LIL ROCKET	(BC)	904
563	SARAH GREENSTREET	AMAZINGGRACIE	(ASSOC)	905
566	MRS M J CORRY-THOMAS	SHANOWL QUIZA WHIZZ SPICE	(BC)	906
573	K K KISIELNICKI	KAYLADENE IGNITE MY FIRE	(BC)	907
574	SARAH MCDOWELL	ZAC JD	(BC)	908
600				
615	SUSAN KERWIN	ALANGLEN KEEP THE FAITH CDX ET	(LAB)	909
618	PETER MARMO	ROZATE THE SEA HAWK	(AUSSIE)	910
623	ADRIAN AND RANA BROGAN	JAMARANG BISKIT BROGAN CDX ET RA	(GOLDIE)	911

Excellent Jumping (G) - Clive Makepeace**Sunday 10th March, 2013 (PM)**

600				
608	MRS K MR G TAYLOR	AUSSIE BUNDY CCD RN JD	(ASSOC)	968
604	FIONA COLENZO	ABBIESTAR SPECIALIZED JD	(VIZSLA)	969
500				
577	KATIE BUGEJA	BLACKDIAMONDTOPY AD JD	(ASSOC)	970
574	SARAH MCDOWELL	ZAC JD	(BC)	971
572	PAULINE GARDNER	DALLAS GARDNER AD JD	(ASSOC)	972
564	LEIGH STRETTON	ASHA (JD)	(BC)	973
549	KATE SCOTT	BELADELE XTREME XCESS JD	(BC)	974
536	STEPHEN PEARSON	ICEANA MERCURY RISEN ET AD JD SPD	(VIZSLA)	975
524	MRS K MR G TAYLOR	NGALLA ONE OF THESE NIGHTS RN AD JD	(AUSSIE)	976
522	LINDENBRAE KENNELS	LINDENBRAE TARFIN FEY CONJURER CCD RN JD AD	(BC)	977
514	STEVE AND TERRI ROSE	KADNOOK BLAZE OF GLORY ADX JD	(LAB)	978
400				
409	MRS K MR G TAYLOR	SILVANWOOD HELLS BELLS RN JD	(AUSSIE)	979

600				
622	MIKA PEACE	DYKINTA RED ALERT ADM JDM ADO JDO GDX SD SPD	(AUSSIE)	912
619	MICHAEL CHESWORTH	KAYLADENE TAKE IT EASY ADX JDX SPD	(BC)	913
617	L K HAMMER AND K A EDWARDS	FENRIK MURPHYS OUTLAW ADM3 ADO3 JDM6 JFO4 SDM GDM SPDM	(GSP)	914
613	GARY STOCKMAN	KIWI MATAI JDX AD	(ASSOC)	915
607	L K HAMMER AND K A EDWARDS	FENIK LIQUORICE ALSPORT ADM2 ADO JDM JDO SDX GDX SPDM	(GSP)	916
603	DR J M MAGAREY	FLYNN JDX ADX SPD SDX GD	(BC)	917
602	KATE DALL	TJUKURPA TRAPPER AD JDX	(KOOLIE)	918
601	KAROLYN DE GRAAUW	AG CH ZIGGY D ADM JDM ADO JDO GD PT SPMD DWDFS	(ASSOC)	919
500				
576	MRS SL AND MR AC SANDERSON	ALANGLN ARWEN ROSE CD ADM ADO JDM JDO SD SPDX GDX	(LAB)	920
575	SANDY STOCKMAN	JETI KNIGHT JDX ADX GD	(KELPIE)	921
571	BELINDA TEBBET	DARGO TEBBET AD JDX SD ET	(ASSOC)	922
569	JULIE LYON	SHEPALIAN DREAMS UNWIND ADM ADO JDM JDO GD SD SPD (IMP UK)	(AUSSIE)	923
568	MEGAN SEMPLE	T CH ALANGLN JINDABYNE ROSE CCD ADM JDM SDX SPDX ET	(LAB)	924
567	MEREDITH MARSHALL	MACZE JDX ADX SPD SD GD	(ASSOC)	925
561	K K KISIELNICKI	HILLCREST JUMPIN JIVE (IMP USA) JDM ADM	(BC)	926
556	MS TRICIA DUNLOP	SASSYBRAT JDX AD	(BC)	927
555	LYNN MUSSETT	PORUSE DUALY BUILT CD JDX AD RN	(AUSSIE)	928
554	R FAGAN	MACYS MYCIC BLUE SAPPHIRE ADM JDM ADO JDO CD FM	(AUSSIE)	929
552	SARAH CROCKER	MACDONALD AD JDX SPD	(ASSOC)	930
551	KERRIE L RYAN	BAILEY GIRL ADM JDM	(ASSOC)	931
546	K K KISIELNICKI	AG CH KAYLADENE TRIPLE CHOC ADM JDM ADO JDO SPDM GDX SDX	(BC)	932
544	J. LEWIS L. LLOYD	GWAERFEYN IVY AD JDX	(BC)	933
543	G KISIELNICKI	AG CH KAYLADENE CHOC ROYAL ADM JDM ADO JDO SPDM GDX SDG	(BC)	934
542	MR G MRS J MILNER	GUIRMERE RUM RUNNER JDX HT	(BC)	935
541	JULIE LYON ANA RICHARDSON	ELLAGANT ITS IN THE GENES ADX JDO JDM2 SPD GDX	(AUSSIE)	936
538	PATRICIA ATTARD PAUL WARD	SCOUTS HONOUR AD JDM	(ASSOC)	937
537	REBEKAH FOORD	MACYS MINIATURE PATCHES CDADO7ADM4JDM6JDO5GDSPXFD	(AUSSIE)	938
532	HEATHER DONALDSON	RICKY DONALDSON ADX JDM	(ASSOC)	939

527	ANNE WARREN	KANEKY ROYAL EDITION ADM ADO GD SD JDX JDO SPD	(TERRIER (MAN))	940
526	RENEE PATTEN	T CH WILLIAM THEBLOODY CDX ET ADM JDM ADO JDO SDM GDX SPDX DWDFH HTMN RN	(ASSOC)	941
525	JANINE FEIL	PADDINGTON CDX ADX JDX RN	(ASSOC)	942
519	VANESSA LOUGHLIN	MAGPIELANE SIGHING WIND CD ADM ADO3 JDM JDO4 GD SPD SD	(NSDTR)	943
518	K K KISIELNICKI	AG CH 500 KAYLADENE BORN TO RUN JDM ADM JDO ADO SPD	(BC)	944
513	G KISIELNICKI	AG CH GUIRMERE JAZZ ADM JDM ADO JDO SPD GDX SD	(BC)	945
512	MR G MRS J MILNER	AG CH YEOVILLE ACCIDENTAL HERO ADM JDM ADO JDO GDM SDM SPDM CD HSAS	(BC)	946
511	JULIE LYON	ALBAJAIL EMBRACE THE RACE ADX JDX	(AUSSIE)	947
506	PATRICIA ATTARD PAUL WARD	HOLLY GOLIGHTLY ADM JDM JDO ADO SPMD	(ASSOC)	948
505	KATE DALL	TJUKURPA WILLOW AD JDM	(KOOLIE)	949
504	KAROLYN DE GRAAUW	PHOEBE ADX JDM	(KELPIE)	950
501	JESS HARMSWORTH	DARCY DIVA CDX ADM JDM ADO JDO GDX SD	(ASSOC)	951
400				
421	LUKE WILBY	ELSPAN BARKLY BLUE ADX JDX	(COCKER)	952
418	HJ RK DIAMOND	HOLLYBRIT SHARP ASA TACK ADM JDM6 SPDX GD	(POODLE (MIN))	953
417	BEL ADELE KENNELS / ANGIE GUNTHER	BEL ADELE XTREME XTACY CCD JDX	(BC)	954
415	MR SCOTT FLETCHER	JEOLENA BOY CANNY GO ADM ADO GDX JDM JDO SPDX SDX	(STAFFIE)	955
413	SUE GONELLI	LEAPIN LEXIE ADM JDM SPDX GD SD	(ASSOC)	956
407	VANESSA LOUGHLIN	GLENMAVE CHAIN REACTION ADM JDX	(NSDTR)	957
405	S. T. OBRIEN	DEBONAIR DARCY ADM ADO JDM JDO SPDM GD	(ASSOC)	958
404	LAURA DISTEFANO	AG CH 400 NELLIE GIRL ADM ADO JDM JDO HT PT GD	(ASSOC)	959
402	BEL ADELE KENNELS / ANGIE GUNTHER	BEL ADELE UR UNIQUE. CDX AD JDX	(BC)	960
300				
309	MS MICHELE MOORE	TOONEYBANK STOPYA NAGGN ADX JDM SDX GD SPD	(SHELTIE)	961
307	DAWN GLANVILLE	JENUIN NINA SIMONE CD RE ADM JDX SD	(POODLE (MIN))	962
305	SHARON MULSHINE	BINDI CD ADM ADO2 JDM JDO2 SD GD	(IGGY)	963
303	S. T. OBRIEN	HENDERCHIP KICKNUP DUST JDM JDO ADX	(POODLE (TOY))	964
302	CAROLE DENEHEY	HENDERCHIP DARTAGNAN JDX FD	(POODLE (TOY))	965

200				
202	KYLEY CONDER	CHEZJOLIE FANCY STUFF CCD JDX AD RN	(POODLE (TOY))	966
201	TAMMY BEATTIE	MADDOGMADISON AD JDX	(ASSOC)	967

Novice Jumping (G) - Clive Makepeace Sunday 10th March, 2013 (PM)

600				
618	PETER MARMO	ROZATE THE SEA HAWK	(AUSSIE)	980
615	SUSAN KERWIN	ALANGLLEN KEEP THE FAITH CDX ET	(LAB)	981
614	MS D M JAMES D L RAE	CH ARANYBAJNOK HUNT MASTER ET	(VIZSLA)	982
500				
578	NECIA LYNCH	DUAL CH TRACKING DEELEE BAMBINI BERNARDO CCD RN	(LAGOTTO)	983
573	K K KISIELNICKI	KAYLADENE IGNITE MY FIRE	(BC)	984
566	MRS M J CORRY-THOMAS	SHANOWL QUIZA WHIZZ SPICE	(BC)	985
565	ELAINE RAWILLER	COOPERRAWILLER	(ASSOC)	986
563	SARAH GREENSTREET	AMAZINGGRACIE	(ASSOC)	987
559	G KISIELNICKI	KAYLADENE ROXYZ LIL ROCKET	(BC)	988
548	MRS K MR G TAYLOR	AUSSIE MIA RN	(ASSOC)	989
531	JOHN FULTON	KELLYNOTGEMMA	(ASSOC)	990
529	MRS ROSALINE TWAITES DR R ATYEO	YEOVILLE MISS INDEPENDENT HT	(BC)	991
509	MS KIERSTEN COULTER	COMEBY MORE THAN ME	(AUSSIE)	992
508	LAURA DISTEFANO	ELLAGANT NEW VENTURE AD HT	(AUSSIE)	993
507	DR J M MAGAREY	GUIRMERE SCOUT GDSPDADSD	(BC)	994
400				
412	MRS H M EAVES	RICOCHYZ DYFRI LILI RHOSLYN TDX	(WELSHIE)	995
300				
311	VICKI JOSEPHS	GLORI	(TERRIER)	996

Novice Jumping (H) - Roger Padfield Sunday 10th March, 2013 (PM)

600				
618	PETER MARMO	ROZATE THE SEA HAWK	(AUSSIE)	997
615	SUSAN KERWIN	ALANGLLEN KEEP THE FAITH CDX ET	(LAB)	998
500				
578	NECIA LYNCH	DUAL CH TRACKING DEELEE BAMBINI BERNARDO CCD RN	(LAGOTTO)	999
573	K K KISIELNICKI	KAYLADENE IGNITE MY FIRE	(BC)	1000
563	SARAH GREENSTREET	AMAZINGGRACIE	(ASSOC)	1001

559	G KISIELNICKI	KAYLADENE ROXYZ LIL ROCKET	(BC)	1002
548	MRS K MR G TAYLOR	AUSSIE MIA RN	(ASSOC)	1003
531	JOHN FULTON	KELLYNOTGEMMA	(ASSOC)	1004
529	MRS ROSALINE TWAITES DR R ATYEO	YEOVILLE MISS INDEPENDENT HT	(BC)	1005
521	SUSAN KERWIN	MATAGANAH SAPPHIRE MOON	(LAB)	1006
509	MS KIERSTEN COULTER	COMEBY MORE THAN ME	(AUSSIE)	1007
507	DR J M MAGAREY	GUIRMERE SCOUT GDSPDADSD	(BC)	1008
400				
414	SALLY BURGESS	OLIVERJAMES RN	(ASSOC)	1009
412	MRS H M EAVES	RICOCHEZ DYFRI LILI RHOSLYN TDX	(WELSHIE)	1010
300				
313	TINA CHESWORTH	YACKAWIL YESTERDAYS DREAM	(SHELTIE)	1011
311	VICKI JOSEPHS	GLORI	(TERRIER)	1012

Excellent Jumping (H) - Roger Padfield

Sunday 10th March, 2013 (PM)

600				
604	FIONA COLENZO	ABBIESTAR SPECIALIZED JD	(VIZSLA)	1013
500				
577	KATIE BUGEJA	BLACKDIAMONDToby AD JD	(ASSOC)	1014
574	SARAH MCDOWELL	ZAC JD	(BC)	1015
572	PAULINE GARDNER	DALLAS GARDNER AD JD	(ASSOC)	1016
564	LEIGH STRETTON	ASHA (JD)	(BC)	1017
549	KATE SCOTT	BELADELE XTREME XCESS JD	(BC)	1018
524	MRS K MR G TAYLOR	NGALLA ONE OF THESE NIGHTS RN AD JD	(AUSSIE)	1019
522	LINDENBRAE KENNELS	LINDENBRAE TARFIN FEY CONJURER CCD RN JD AD	(BC)	1020
514	STEVE AND TERRI ROSE	KADNOOK BLAZE OF GLORY ADX JD	(LAB)	1021
400				
401	VICKI JOSEPHS	DEMON AD JD SPD SD RN	(POODLE (MIN))	1022

Masters Jumping (H) - Roger Padfield

Sunday 10th March, 2013 (PM)

600				
625	L K HAMMER AND K A EDWARDS	PACE VON DER MADLAGE (IMP DEU) ADX ADO JDX SD GD SPDX	(GSP)	1023
622	MIKA PEACE	DYKINTA RED ALERT ADM JDM ADO JDO GDX SD SPD	(AUSSIE)	1024
619	MICHAEL CHESWORTH	KAYLADENE TAKE IT EASY ADX JDX SPD	(BC)	1025

613	GARY STOCKMAN	KIWI MATAI JDX AD	(ASSOC)	1026
611	MRS JENNY WILLIAMS	ROBBIE JAY ADX ADO JDO JDM	(ASSOC)	1027
605	STEVE AND TERRI ROSE	KADNOOK GROUSES LEGEND ADM JDX	(LAB)	1028
603	DR J M MAGAREY	FLYNN JDX ADX SPD SDX GD	(BC)	1029
602	KATE DALL	TJUKURPA TRAPPER AD JDX	(KOOLIE)	1030
601	KAROLYN DE GRAAUW	AG CH ZIGGY D ADM JDM ADO JDO GD PT SPMD DWDFS	(ASSOC)	1031
500				
576	MRS SL AND MR AC SANDERSON	ALANGLLEN ARWEN ROSE CD ADM ADO JDM JDO SD SPDX GDX	(LAB)	1032
575	SANDY STOCKMAN	JETI KNIGHT JDX ADX GD	(KELPIE)	1033
571	BELINDA TEBBET	DARGO TEBBET AD JDX SD ET	(ASSOC)	1034
569	JULIE LYON	SHEPALIAN DREAMS UNWIND ADM ADO JDM JDO GD SD SPD (IMP UK)	(AUSSIE)	1035
568	MEGAN SEMPLE	T CH ALANGLLEN JINDABYNE ROSE CCD ADM JDM SDX SPDX ET	(LAB)	1036
567	MEREDITH MARSHALL	MACZE JDX ADX SPD SD GD	(ASSOC)	1037
561	K K KISIELNICKI	HILLCREST JUMPIN JIVE (IMP USA) JDM ADM	(BC)	1038
558	MR GARRY C HEINZE	BILLYDOGHEINZE AD JDX	(ASSOC)	1039
556	MS TRICIA DUNLOP	SASSYBRAT JDX AD	(BC)	1040
555	LYNN MUSSETT	PORUSE DUALY BUILT CD JDX AD RN	(AUSSIE)	1041
554	R FAGAN	MACYS MYCIC BLUE SAPPHIRE ADM JDM ADO JDO CD FM	(AUSSIE)	1042
552	SARAH CROCKER	MACDONALD AD JDX SPD	(ASSOC)	1043
551	KERRIE L RYAN	BAILEY GIRL ADM JDM	(ASSOC)	1044
546	K K KISIELNICKI	AG CH KAYLADENE TRIPLE CHOC ADM JDM ADO JDO SPDM GDX SDX	(BC)	1045
544	J. LEWIS L. LLOYD	GWAERFEYN IVY AD JDX	(BC)	1046
543	G KISIELNICKI	AG CH KAYLADENE CHOC ROYAL ADM JDM ADO JDO SPDM GDX SDG	(BC)	1047
542	MR G MRS J MILNER	GUIRMERE RUM RUNNER JDX HT	(BC)	1048
541	JULIE LYON ANA RICHARDSON	ELLAGANT ITS IN THE GENES ADX JDO JDM2 SPD GDX	(AUSSIE)	1049
538	PATRICIA ATTARD PAUL WARD	SCOUTS HONOUR AD JDM	(ASSOC)	1050
537	REBEKAH FOORD	MACYS MINIATURE PATCHES CDADO7ADM4JDM6JDO5GDSPXFDM	(AUSSIE)	1051
535	JESS HARMSWORTH	ZEE AD JDX GD	(ASSOC)	1052
532	HEATHER DONALDSON	RICKY DONALDSON ADX JDM	(ASSOC)	1053
527	ANNE WARREN	KANEKY ROYAL EDITION ADM ADO GD SD JDX JDO SPD	(TERRIER (MAN))	1054
526	RENEE PATTEN	T CH WILLIAM THEBLOODY CDX ET ADM JDM ADO JDO SDM GDX SPDX DWDFFA HTMN RN	(ASSOC)	1055
525	JANINE FEIL	PADDINGTON CDX ADX JDX RN	(ASSOC)	1056
519	VANESSA LOUGHLIN	MAGPIELANE SIGHING WIND CD ADM ADO3 JDM JDO4 GD SPD SD	(NSDTR)	1057

518	K K KISIELNICKI	AG CH 500 KAYLADENE BORN TO RUN JDM ADM JDO ADO SPD	(BC)	1058
513	G KISIELNICKI	AG CH GUIRMERE JAZZ ADM JDM ADO JDO SPD GD SD	(BC)	1059
512	MR G MRS J MILNER	AG CH YEOVILLE ACCIDENTAL HERO ADM JDM ADO JDO GDM SDM SPDM CD HSAS	(BC)	1060
511	JULIE LYON	ALBAJAIL EMBRACE THE RACE ADX JDX	(AUSSIE)	1061
506	PATRICIA ATTARD PAUL WARD	HOLLY GOLIGHTLY ADM JDM JDO ADO SPMD	(ASSOC)	1062
505	KATE DALL	TJUKURPA WILLOW AD JDM	(KOOLIE)	1063
504	KAROLYN DE GRAAUW	PHOEBE ADX JDM	(KELPIE)	1064
502	STEPHEN PEARSON	FIDELS IN HOT PURSUIT ADX JDX	(BC)	1065
501	JESS HARMSWORTH	DARCY DIVA CDX ADM JDM ADO JDO GD SD	(ASSOC)	1066
400				
418	HJ RK DIAMOND	HOLLYBRIT SHARP ASA TACK ADM JDM6 SPDX GD	(POODLE (MIN))	1067
417	BEL ADELE KENNELS / ANGIE GUNTHER	BEL ADELE XTREME XTACY CCD JDX	(BC)	1068
416	M A SCHNIDER	MONTULATA JADES GEM CCD ADX JDX SD GD SPD	(BC)	1069
415	MR SCOTT FLETCHER	JEOLENA BOY CANNY GO ADM ADO GD SD JDM JDO SPDX SDX	(STAFFIE)	1070
407	VANESSA LOUGHLIN	GLENMAVE CHAIN REACTION ADM JDX	(NSDTR)	1071
405	S. T. OBRIEN	DEBONAIR DARCY ADM ADO JDM JDO SPDM GD	(ASSOC)	1072
404	LAURA DISTEFANO	AG CH 400 NELLIE GIRL ADM ADO JDM JDO HT PT GD	(ASSOC)	1073
402	BEL ADELE KENNELS / ANGIE GUNTHER	BEL ADELE UR UNIQUE. CDX AD JDX	(BC)	1074
300				
309	MS MICHELE MOORE	TOONEYBANK STOPYA NAGGN ADX JDM SDX GD SPD	(SHELTIE)	1075
307	DAWN GLANVILLE	JENUIN NINA SIMONE CD RE ADM JDX SD	(POODLE (MIN))	1076
305	SHARON MULSHINE	BINDI CD ADM ADO2 JDM JDO2 SD GD	(IGGY)	1077
303	S. T. OBRIEN	HENDERCHIP KICKNUP DUST JDM JDO ADX	(POODLE (TOY))	1078
302	CAROLE DENEHEY	HENDERCHIP DARTAGNAN JDX FD	(POODLE (TOY))	1079
301	VICKI JOSEPHS	SUMMASTORM JDX AD SDX SPDX GD CCD	(TERRIER)	1080
200				
201	TAMMY BEATTIE	MADDOGMADISON AD JDX	(ASSOC)	1081

Please note:

We will be conducting Agility/Jumping Trials on 2nd & 3rd November, 2013, we will again look forward to your support and hope to see you all back in Warrnambool then.

We will also be seeking Sponsorship for trophies, raffle donations and helpers for this trial, if you can assist and are available to help, please email wdtstrialsec@eftel.net.au.

Safe travelling to everyone, see you at the next trial.